

Washington Park Arboretum



Multi-use Trail

January 28, 2015

Public Information Campaign

Meetings	Date	Other Outreach: Websites
Friends of Seattle Olmsted Parks	6/6/2011	Seattle Parks and Recreation Arboretum Multi-Use Trail Project Information
ABGC Project Presentation	6/8/2011	University of Washington Botanic Gardens 520 Updates
		WSDOT: "SR 520 Bridge Replacement Program Updates"
Public Meeting #1: "Multi-Use Trail"	6/8/2011	WSDOT: "SR 520 Bridge Replacement Project Mitigation Presentation"
		Blogs 2014
Public Meeting #2: "Multi-Use Trail"	8/31/2011	Montlake Neighborhood Blog: "New Multi-Use Trail Coming to the Arboretum"
Seattle Bicycle Advisory Board	4/4/2012	Montlake Community Club Blog: "Feb 27 Arboretum Multi-Use Trail Approaching Final Design"
Seattle Pedestrian Advisory Board	5/12/2012	Madison Park Blogger: "Arboretum Rehab Plan Revealed"
Seattle Design Commission	5/3/2012	Seattle Bike Blog: "State Will Fund New Arboretum Trail"
Fiends of Seattle Olmsted Parks	1/6/2014	Sustainable City Network: "Arboretum & WSDOT Reach \$7.8 Million Agreement"
Seattle Bicycle Advisory Board	1/8/2014	Seattle Parks and Recreation "Parkways" Blog (1/24)
Madison Community Council	2/3/2014	Seattle Parks and Recreation "Parkways" Blog (2/14)
Seattle Pedestrian Advisory Board	2/12/2014	News Sources 2014
		King 5 News: "Arboretum Trades Empty Ramps for New Trails"
Public Meeting #3: "Multi-Use Trail"	2/27/2014	Komo 4 News: "Arboretum Gets \$7.8 Million for New Trail, Improvements"
Montlake Community Council	3/4/2014	Seattle Times: "State to Tear Down Highway 520 'Ramps to Nowhere'"
ABGC Tour of Trail	3/12/2014	Curbed Seattle: "Washington Park Arboretum Getting \$7.8M Facelift"
Seattle Design Commission	3/20/2014	Madison Valley News: "Arboretum Multi-Use Trail Public Meeting"
		Capitol Hill Times: "Arboretum to Undergo Historical Expansion, Remove Bridges to Nowhere"
		Press Releases 2014
Committee and board meetings listed are open to the public		Arboretum and WSDOT Reach Ground Breaking \$7.8 Million Agreement

Site Overview



Renewing Washington Park Arboretum Master Plan – December 2000

Multi-use Trail

-A safer route for recreational bike users



Arboretum Loop Trail

E. Madison Street



Typical Trail Cross Section

- Trail pavement – Asphalt.
- Shoulder – Crushed rock.
- Trail Restoration – Native plantings.

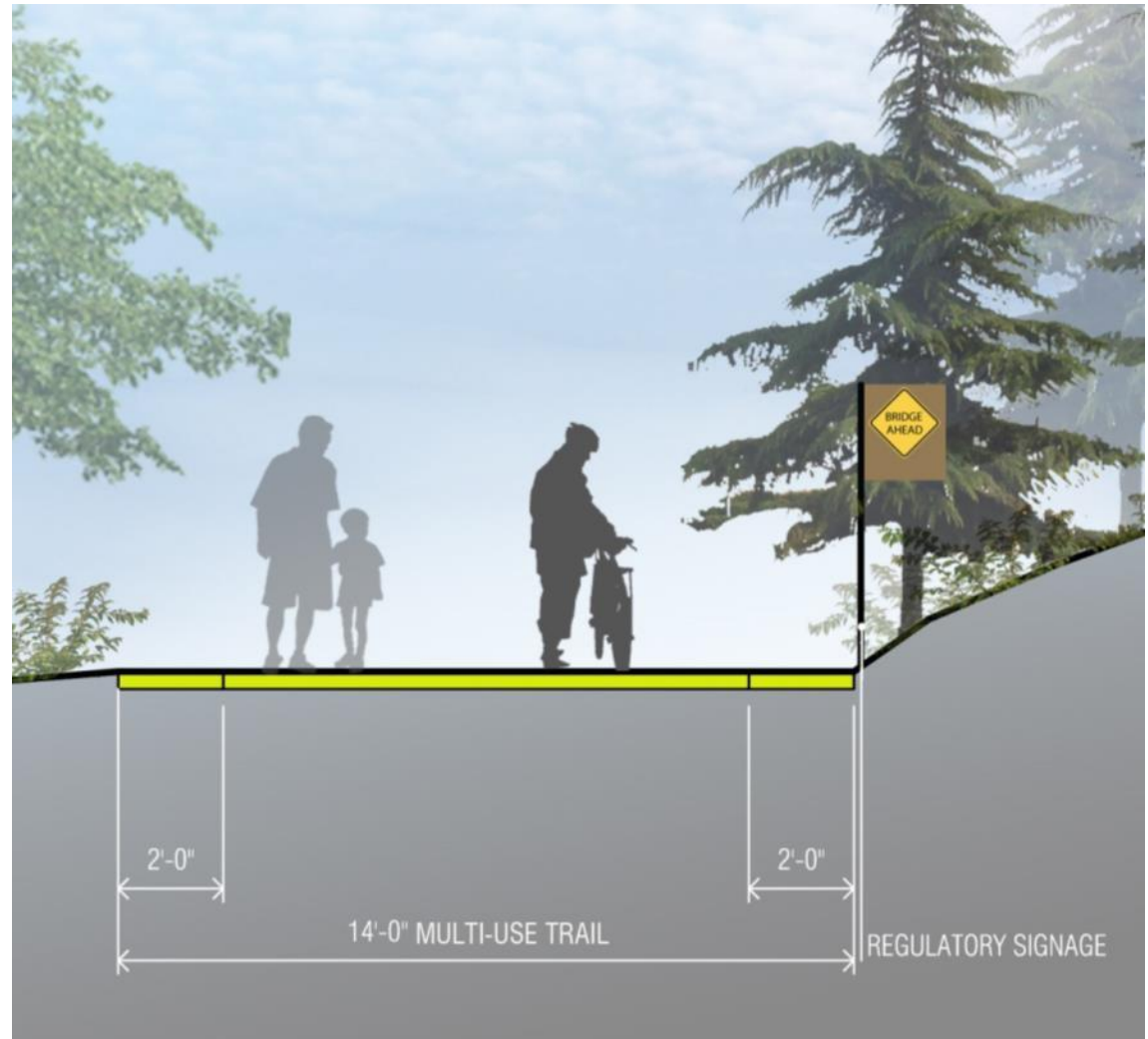

Schedule

- Bidding first quarter of 2015
- Construction start spring 2015
- Construction through December 2016
- Construction to occur in phases
- Weather dependent

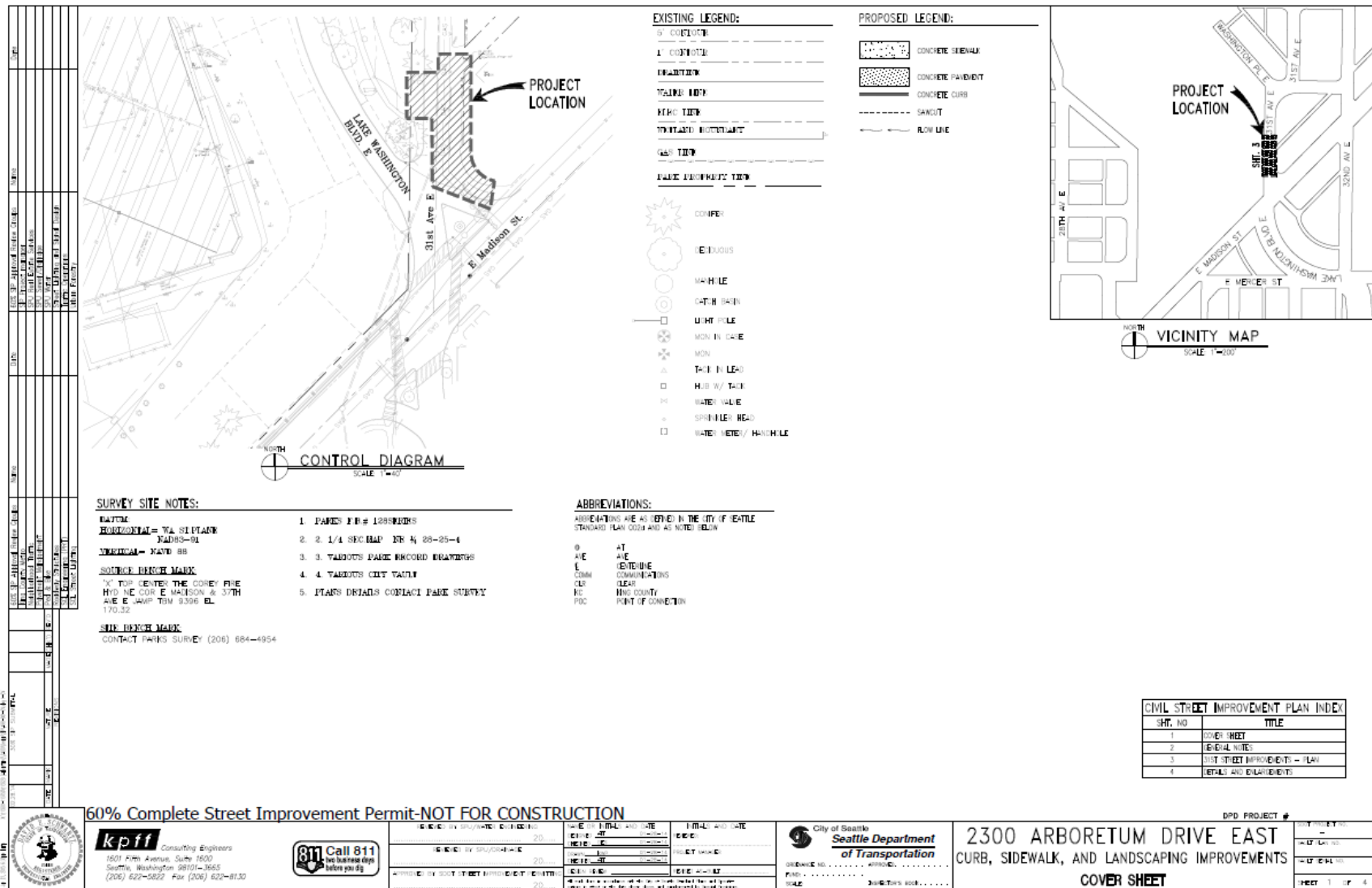

REVIEWED BY SPU/WATER ENGINEERING	20.....
REVIEWED BY SPU/DRAINAGE	20.....
APPROVED BY SDOT STREET IMPROVEMENT PERMITTING	20.....

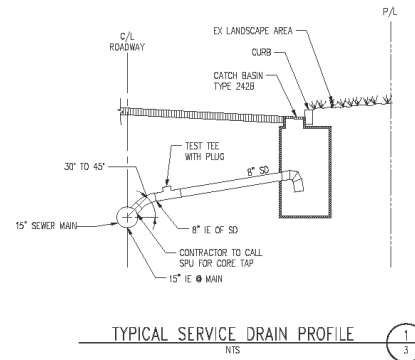

BOOT PROJECT NO.
—
VAULT PLAN NO.
VAULT SERIAL NO.
SHEET 4 OF 4

EMAIL UPDATES

- <http://www.seattle.gov/parks/projects/arboretum/trail.htm>

Seattle Parks and Recreation

[Home](#) | [About Us](#) | [Contact Us](#)
[Explore More](#)

Christopher Williams, Acting Superintendent

[Parks](#) | [Centers & Pools](#) | [Activities](#) | [Reservations & Permits](#) | [Projects & Planning](#) | [A - Z Index](#)

Projects & Planning

- ☐ Parks Legacy Plan
- ☐ Partnerships
- ☐ Natural Area Greenbelt Use

☒ Parks and Green Spaces Levy

- ☐ Pro Parks Levy
- ☐ Community Center Levy
- ☐ Major Maintenance
- ☐ Neighborhood Matching Fund
- ☐ Horticulture
- ☐ Sustainable Building & Development
- ☐ City-Wide Planning Documents
- ☐ Plans for Individual Parks
- ☐ Parks Standards
- ☐ Policies and Agreements
- ☐ Requests for Proposals
- ☐ Requests for Qualifications
- ☐ Board of Park Commissioners
- ☐ Seattle Conservation Corps



Washington Park Arboretum Multi-Use Trail Project Information

Location: 2300 Arboretum Dr E, Seattle WA 98112

PROJECT STATUS

January 2015

Parks and the design team are working to complete permitting and finalize the construction documents. Parks and the University Of Washington are working to begin moving and propagating collection plantings.

October 2014

The design team is working with our partners at the University of Washington to complete construction documents for bidding this winter.

The final design development plan was presented at the Multi-Use Trail project's final public meeting on February 27, 2014. (See presentation [below](#).) Thank you to those who have participated in the public process for the project.

The multi-use trail was identified in the Arboretum master plan that was adopted in 2000. The trail was identified as a way to enhance the visitor experience of Washington Park Arboretum. Intended for use by both pedestrians and bicyclists, the curving path is designed to preserve vegetation and control speed.

The Berger Partnership was awarded the design contract after Parks conducted a Request for Proposal (RFP) and interview process. Construction is anticipated to commence in 2015.

This project initially provided scoping and conceptual design for a redeveloped North Entry to Washington Park Arboretum and a multi-use trail from the intersection of East Madison to the North Entry and the Montlake and University neighborhoods beyond. The Consultant Selection Committee recommended that the Berger Partnership be

EVENTS

Public Meeting

Wednesday, January 28, 2015
6:30 - 7:45 p.m.
Graham Visitors Center
2300 Arboretum Dr E
Seattle, 98112

Parks will update the community with project status, anticipated construction impacts and focus on proposed changes to 31st Avenue E at the south end of the trail

- [Meeting Poster](#)

Arboretum Loop Trail E-News Updates

Add or remove your e-mail address from our distribution list.

E-mail address:

☒ Add ☐ Remove

FOR MORE INFORMATION

Garrett Farrell
800 Maynard Ave S,
Suite 300
Seattle, WA 98134
206-233-7921
garrett.farrell@seattle.gov



[Bridge Concept](#)

