



DAC Meeting #11



Westlake Cycle Track - Design Advisory Committee
CJ Holt & Dawn Schellenberg
June 2, 2015

SDOT's mission & vision

Mission: delivering a high-quality transportation system for Seattle.



Vision: connected people, places, and products.

Committed to 5 core values

Create a city that is:

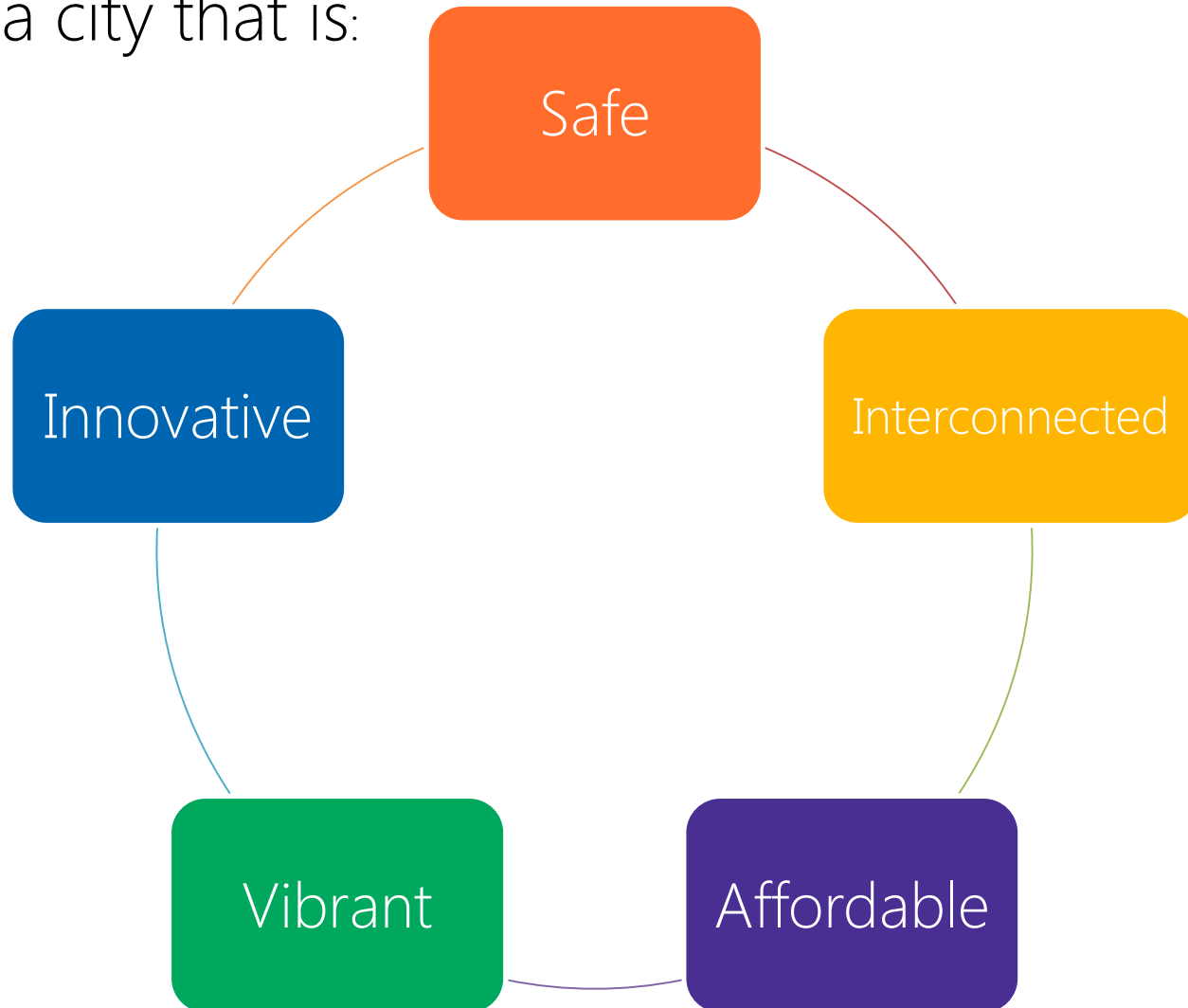

Presentation overview

- How cycle tracks improve safety
- How open issues at 90% design were resolved
- Share 100% design
- Education and monitoring



How the cycle track improves safety for all users

People biking

- Support bicycle riders of all ages and abilities

People walking

- Separate bicycles from pedestrians
- Includes formal pedestrian crossings

People driving

- Provide predictability within parking area

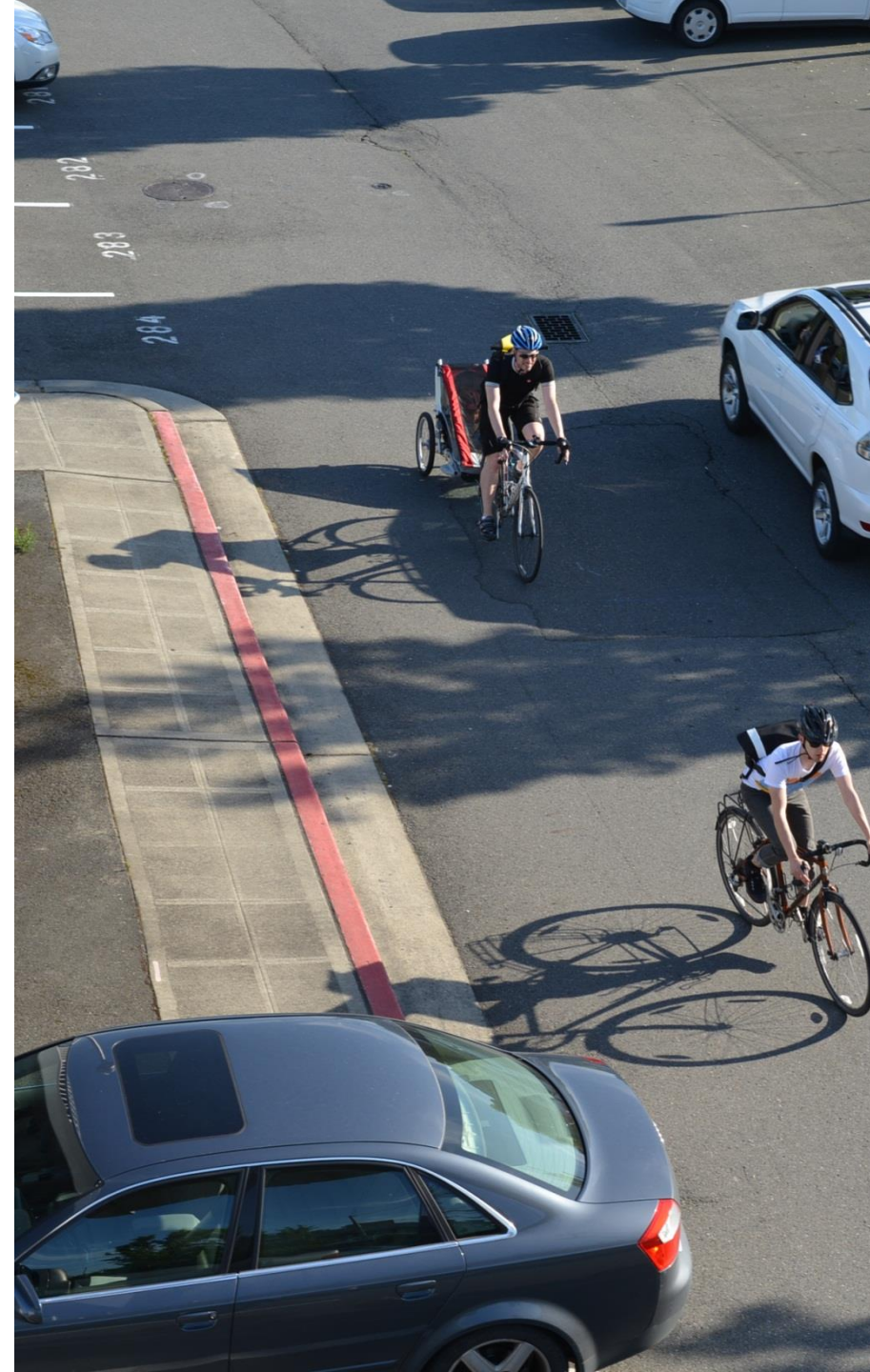

How has SDOT's experience informed the Westlake Cycle Track?



Alki Ave

How has SDOT's experience informed the Westlake Cycle Track?



How has SDOT's experience informed the Westlake Cycle Track?



Broadway Ave

How has SDOT's experience informed the Westlake Cycle Track?



Second Ave

How the DAC and public feedback influenced project design



- Clearly marked, formal pedestrian crossings
- Maximized parking with smaller stalls, angled parking and one-way circulation
- Add speed humps and stop signs to calm parking area and discourage bicycle use

How the DAC and public feedback influenced project design



- Improve ADA accessibility from parking area to businesses
- Improve mixing zone at north end
- Preserve Railroad Park
- Add signal at Driveway 2

How open issues at 90% design were resolved

- Corridor accessibility
- Speed hump dimensions
- Railroad Park
- North end connection
- Driveway safety
- Final parking counts
- Highland Drive

Corridor accessibility

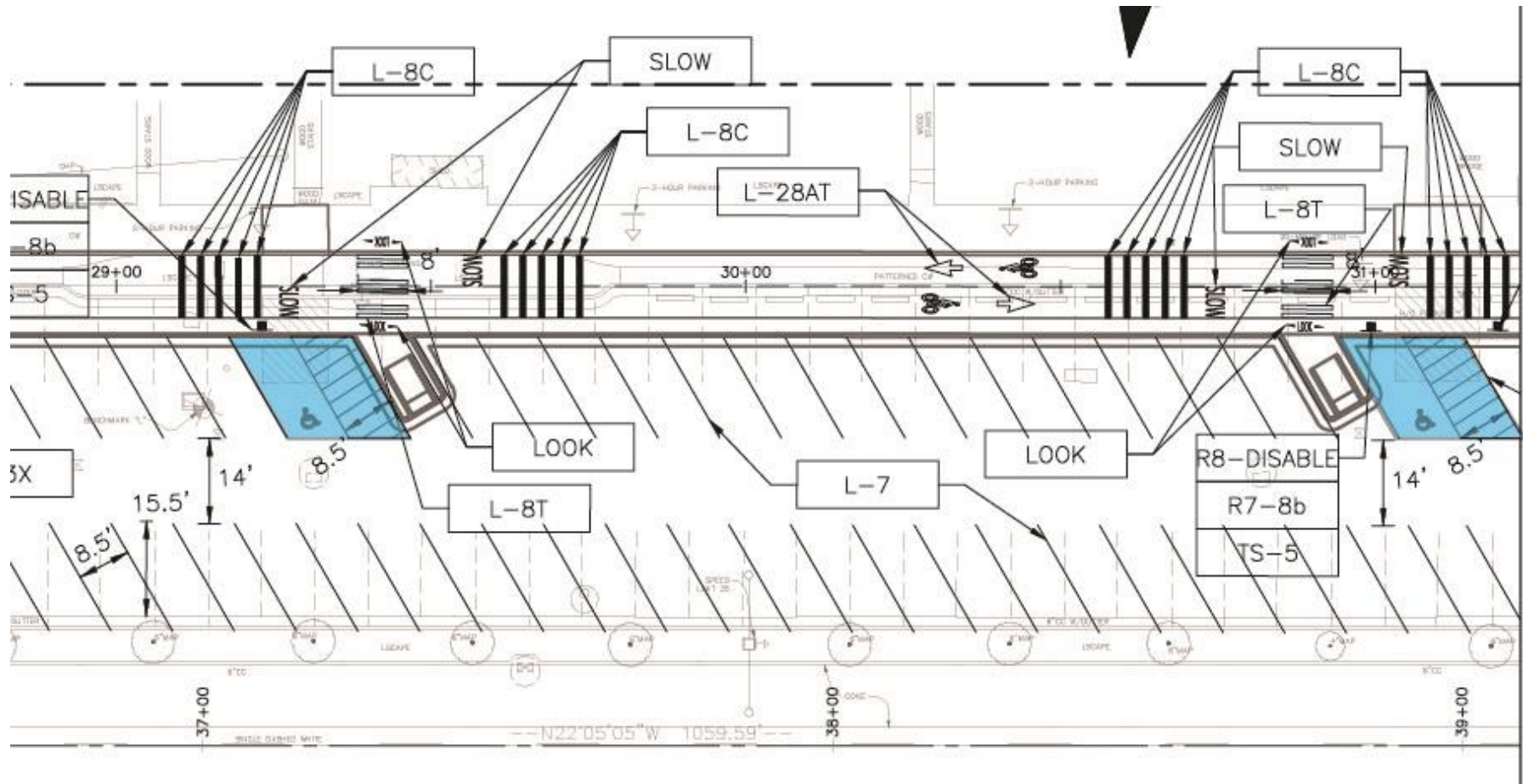

Speed hump dimensions

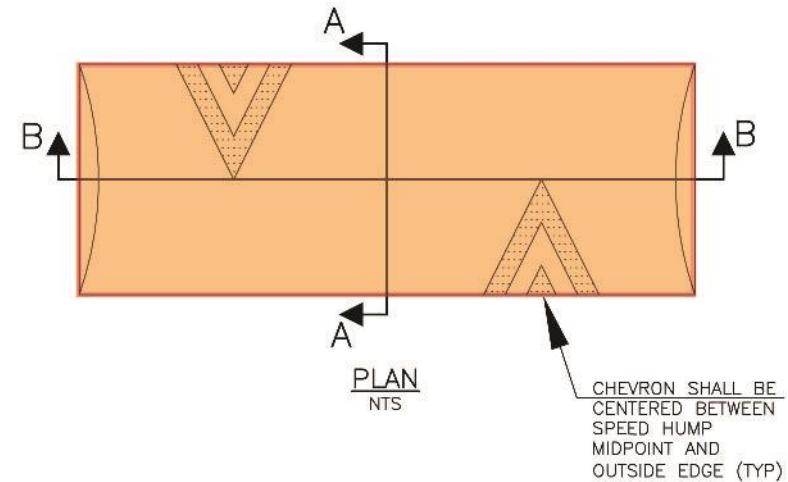
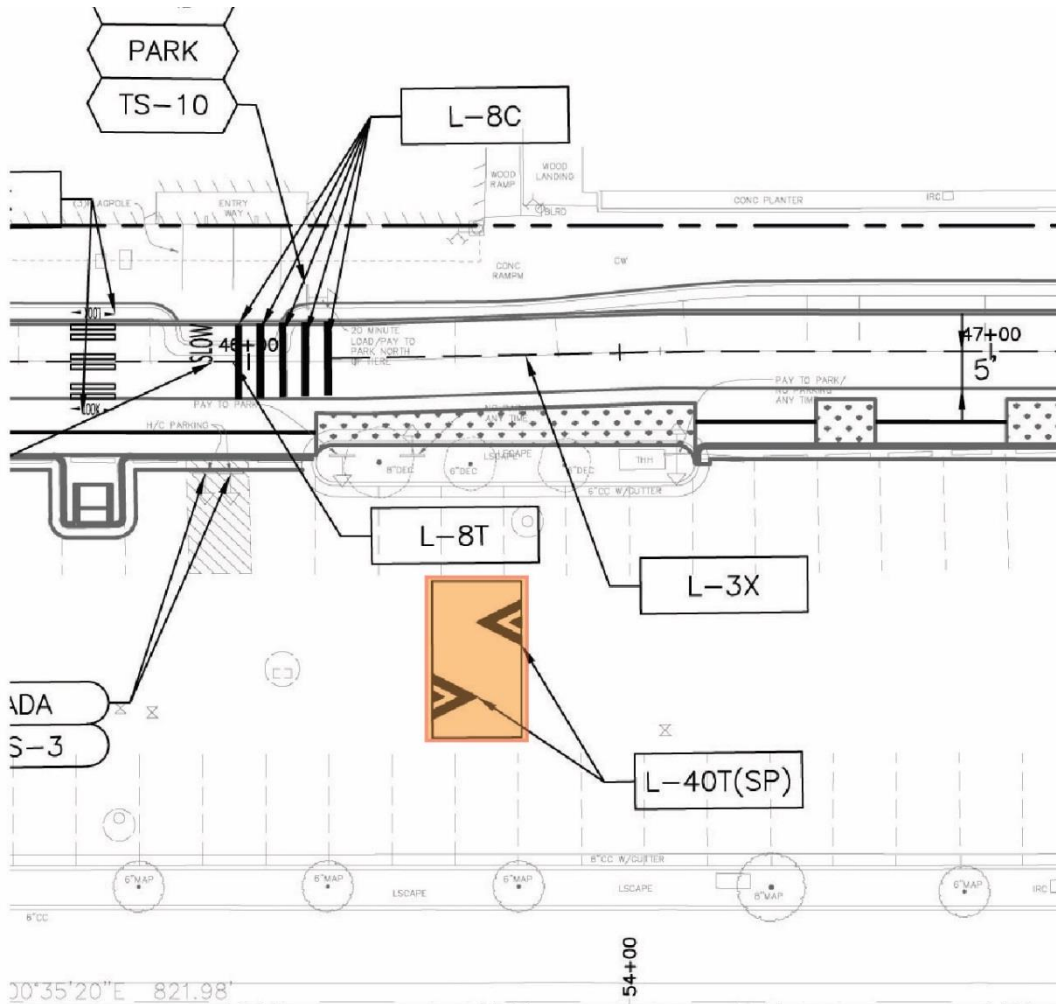

DETAIL 1 - SPEED HUMP

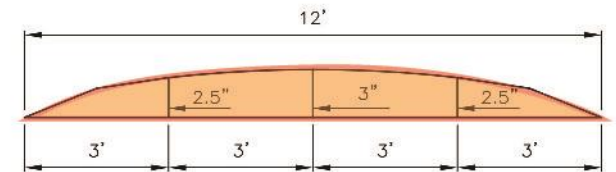

SECTION A-A
NTS(V:H = 4:1)

Railroad Park design

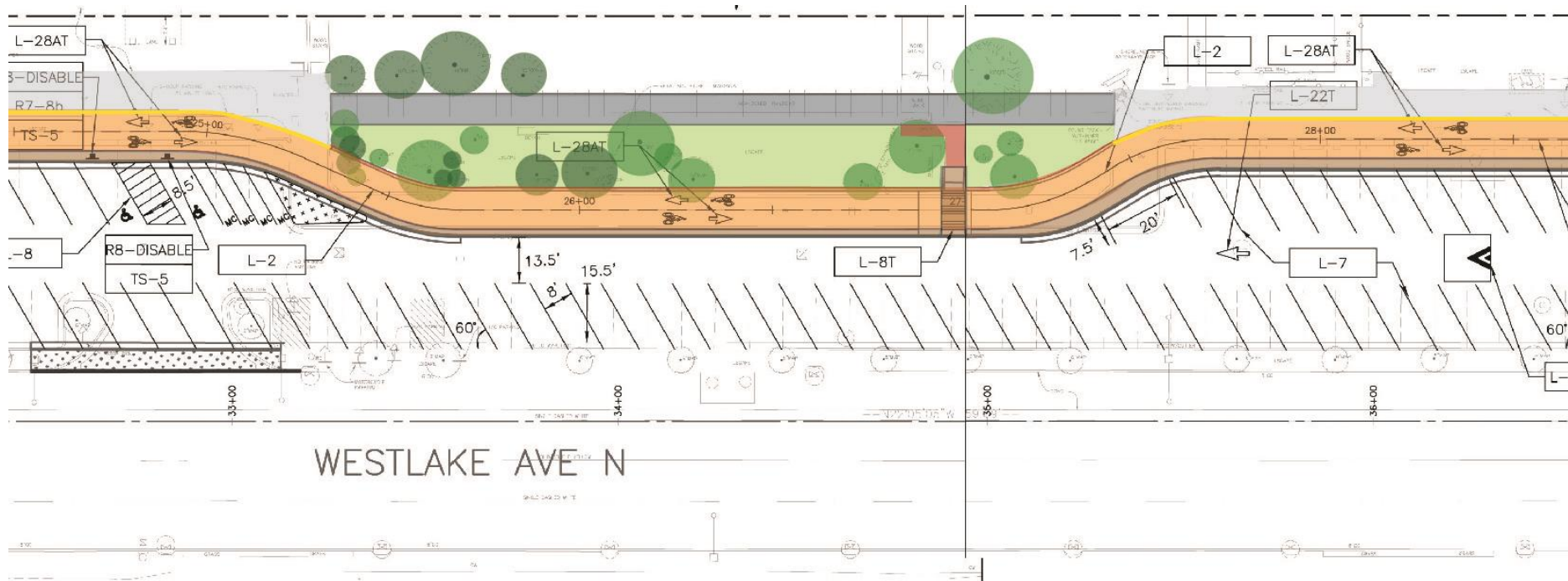

North end connection details

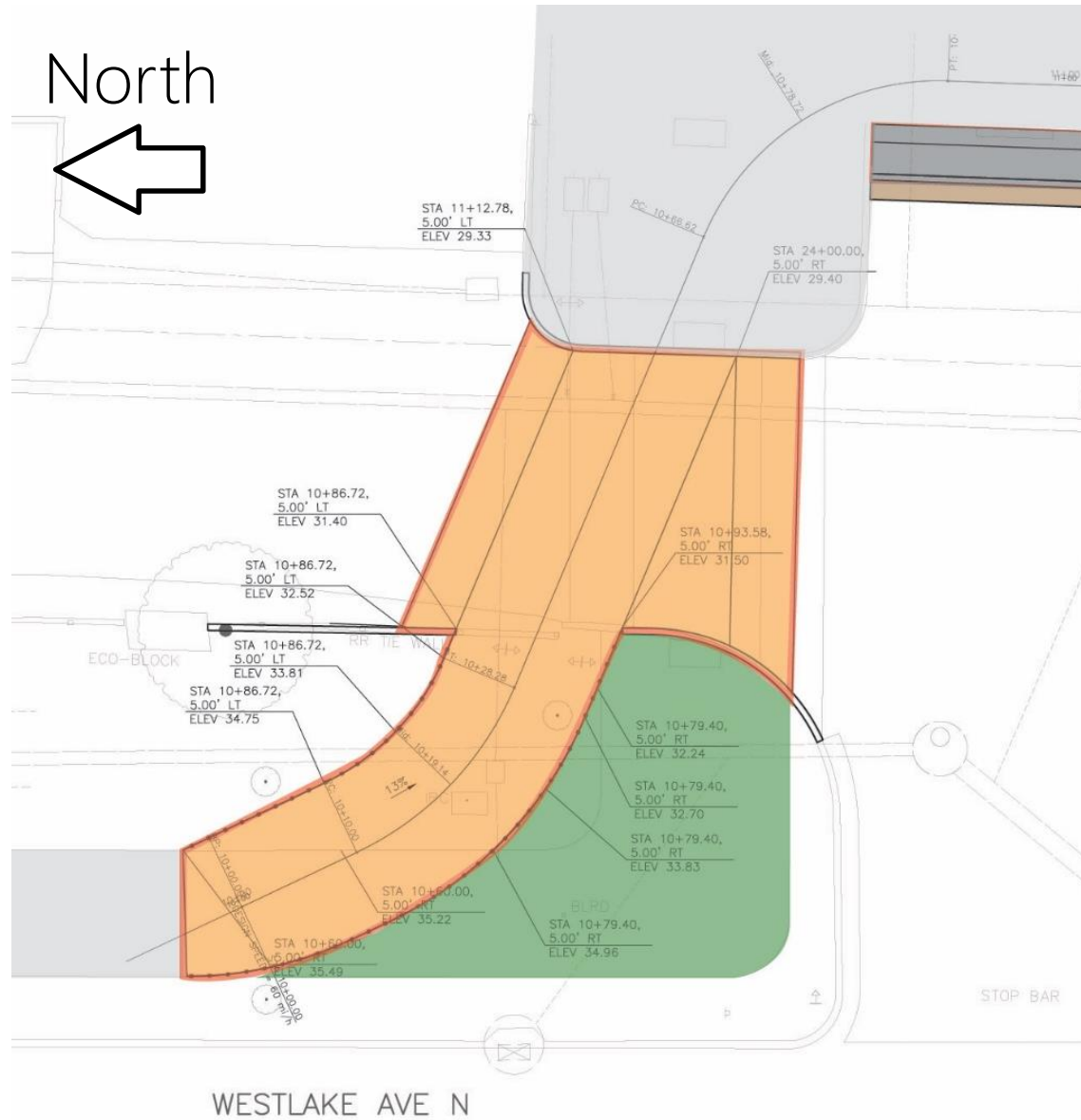

Corridor driveway safety

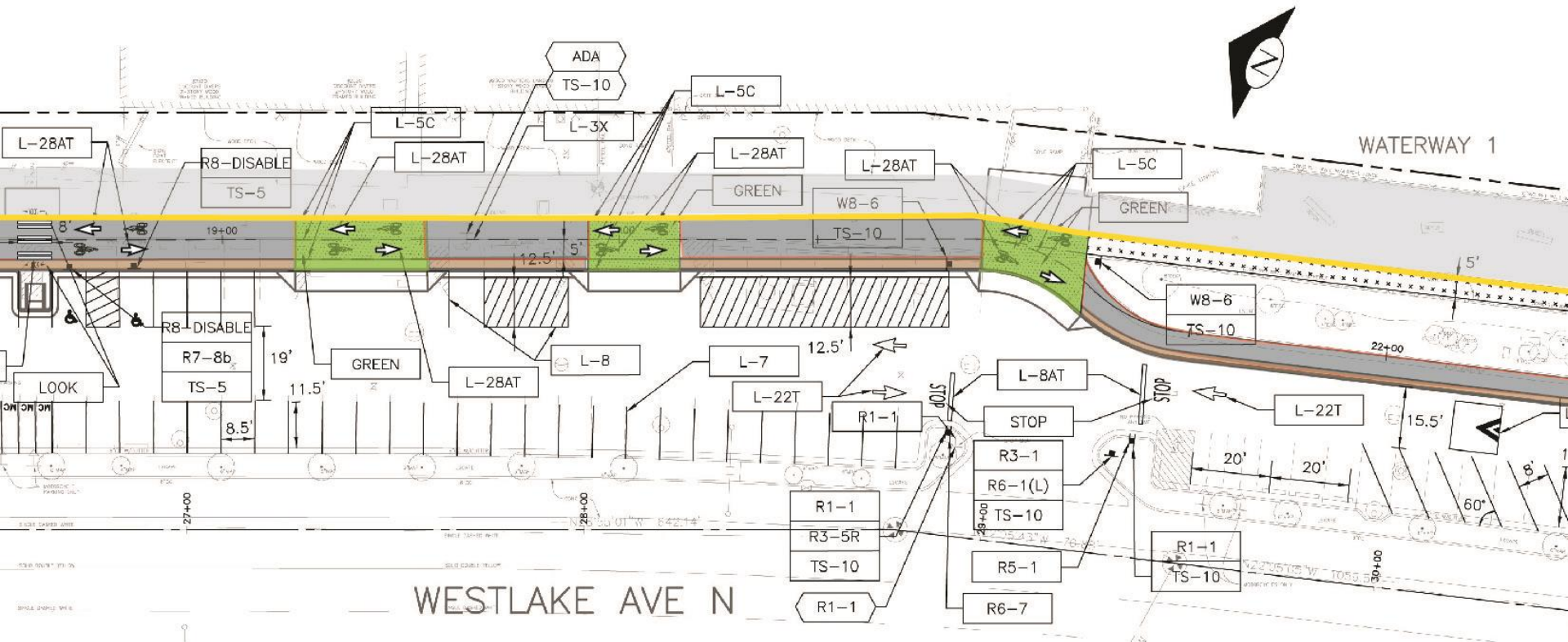

Nautical Landing example

Driveway safety—guideline

National Association of City Transportation Officials

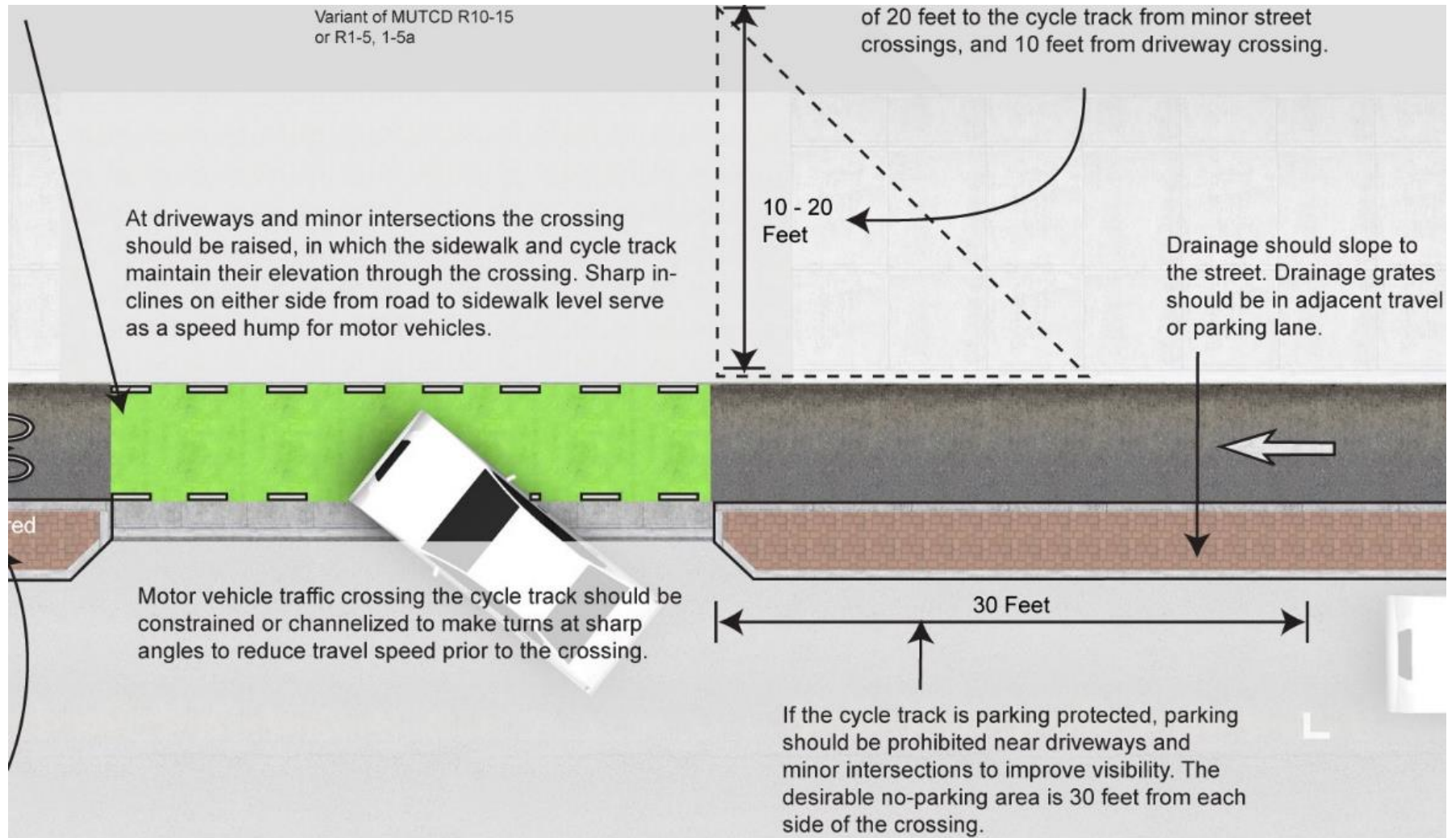

American Association of State Highway Transportation Officials



Final parking counts

Preserved overall: 90%

Corridor Segment	Percentage Preserved
South	89%
Central	87%
North	93%

Highland Drive

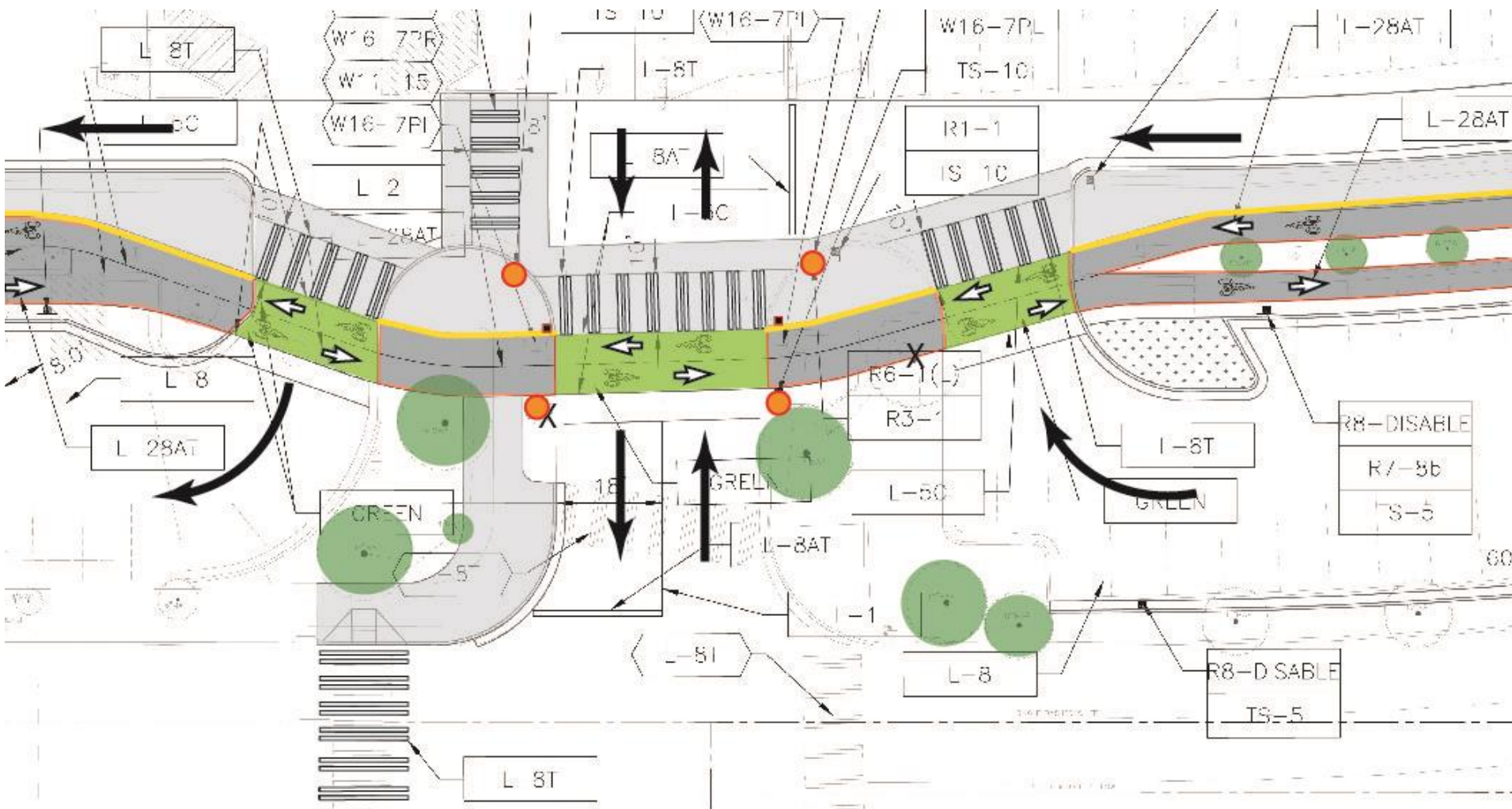

Break

SEPA notification

- Mid-May: Notice of Action mailed to corridor
- Through June 16: Review period



City of Seattle

Edward B. Murray, Mayor

Department of Transportation

Scott Kubly, Director

NOTICE OF ACTION
SEATTLE DEPARTMENT OF TRANSPORTATION
WESTLAKE CYCLE TRACK

Notice is given under the State Environmental Policy Act (SEPA) Revised Code of Washington (RCW) 43.21C.080, that the Seattle Department of Transportation (SDOT) took the action described in (2) below on 4/29/15.

1. Any action to set aside, enjoin, review, or otherwise challenge such action on the grounds of noncompliance with the provisions of chapter 43.21C RCW (SEPA) shall be commenced on or before 5/16/15.

2. Description of agency action: Proceed with construction of the Westlake Cycle Track as evidenced by approval of 100% design.

3. Description of proposal: SDOT proposes to build the Westlake Cycle Track. Work involves repair and replacement of portions of the existing sidewalk and asphalt parking lot. Currently the sidewalk serves both bicyclists and pedestrians and this project would allow for a separated bicycle path. The asphalt cycle track will be approximately 1.2 miles in length and will be located along the eastern alignment of the parking lot.

Construction of the cycle track and curb and gutter will be performed by removal and replacement of only the asphalt pavement. Asphalt pavement will be poured on top of the existing surface in some parts of the project. Drainage patterns will not be modified in the project area. New inlets, catch basins, and manholes will be constructed to replace any drainage facilities impacted by the cycle track. Pedestrian level lighting will be added to enhance safety along the corridor. New landscaping areas will be created as part of the project to replace areas being impacted by the cycle track alignment.

4. Location of proposal: The project is located within the City of Seattle in the Westlake neighborhood, along Westlake Avenue N. From the south, the trail starts at Lake Union Park and extends north to the start of the Ship Canal Trail, 1,000 feet north of Halladay Street.

5. Type of environmental review under SEPA: Categorical Exemption under Seattle Municipal Code (SMC) 25.05.800 (B.3), determined by SDOT February 04, 2015.

6. For further information please contact Peter Drakos at (206) 684-5695 or peter.drakos@seattle.gov.

7. Name of agency, proponent, or applicant giving notice: SDOT

8. This notice is filed by: Scott Kubly, Director, SDOT and SEPA Responsible Official.

Signature: 

Date: 5/4/15

Seattle Municipal Tower
700 5th Avenue
Suite 3800
PO Box 34996
Seattle, Washington 98124-4996

Tel (206) 684-ROAD / (206) 684-5000
Fax: (206) 684-5180
Hearing Impaired use the Washington Relay Service (7-1-1)
www.seattle.gov/transportation

Policy issues

Results of 5/27 Westlake stakeholder/SDOT staff meeting:

- Parking area speed limit
- People bicycling in parking area
- Traffic signal installation at Westlake Ave N driveways
- “Don’t Block the Box” pavement markings
- “Bikes Yield to Peds” signs

Education

NEW! SECOND AVENUE *PROTECTED BIKE LANE*

DEMONSTRATION PROJECT

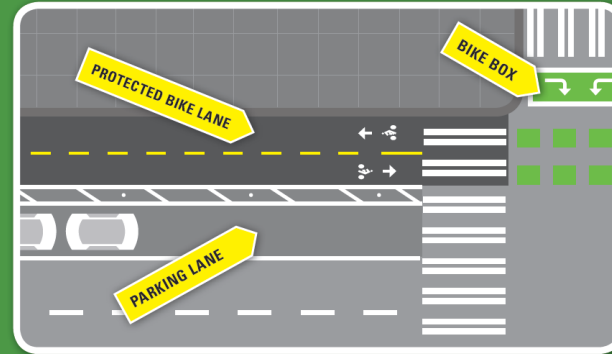

WHAT YOU NEED TO KNOW

The new two-way protected bike lane between Pike Street and Yesler Way will change the way you ride on Second Avenue—learn how to use it safely. ➤



Photo credit: Cascade Bicycle Club



Monitoring

One
month

- Education
- Observation
- Stakeholder meeting
- Modify

Six
months

- High-level evaluation of compliance, parking data, intersection (driveway) data
- Stakeholder meeting

One
year

- Post-installation evaluation
- Expand on six-month data, review results of modifications, collision data, enforcement information

Next steps

June	Contract ad
July	Design info drop-in session RPZ public hearing
September	Begin construction On-going outreach
Spring 2016	Cycle track open Monitoring starts

Thank you
DAC and community members!

Questions?

WCT@seattle.gov | (206) 909-8578

<http://www.seattle.gov/transportation/wct.htm>

<http://www.seattle.gov/transportation>

