

DETAIL AND SECTION REFERENCING

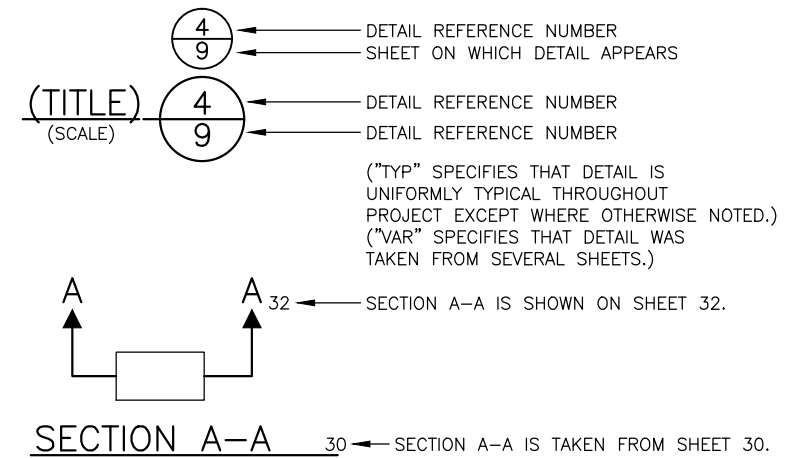

| SCHEDULE | SHEET | DRAWING | SHEET DESCRIPTION |
|------------|-------|-----------|---------------------|
| BASE BID | 1 | CV1 | COVER |
| BASE BID | 2 | NT1 | NOTES |
| ADDITIVE 1 | 3-8 | PV1-PV6 | PAVING PLAN |
| BASE BID | 9-11 | PV7-PV9 | PAVING PLAN |
| ADDITIVE 3 | 12-14 | PV10-PV12 | PAVING PLAN |
| ADDITIVE 2 | 15-17 | PV13-PV15 | PAVING PLAN |
| ADDITIVE 1 | 18-23 | CH1-CH6 | CHANNELIZATION PLAN |
| BASE BID | 24-26 | CH7-CH9 | CHANNELIZATION PLAN |
| ADDITIVE 3 | 27-29 | CH10-CH12 | CHANNELIZATION PLAN |
| ADDITIVE 2 | 30-32 | CH13-CH15 | CHANNELIZATION PLAN |

CV1
COVER

2015 ARTERIAL ASPHALT
AND CONCRETE
ROOSEVELT WAY NE

| | |
|----------------|---------|
| PC | TA6067A |
| R/W | |
| CO | TA6067C |
| VAULT PLAN NO. | |
| --- | |
| SHEET | 1 OF # |

APPROVED FOR ADVERTISING
NANCY LOCKE
DEPARTMENT OF FINANCE & ADMINISTRATIVE SERVICES
SEATTLE, WASHINGTON 20

By: _____
PURCHASING & CONTRACTING SERVICES DIRECTOR

| | | |
|---|-------------------|--------------------|
| NAME OR INITIALS AND DATE | INITIALS AND DATE | |
| DESIGNED | REVIEWED: | |
| CHECKED | DES. | CONST. |
| | SDOT | PROJ. MGR. |
| DRAWN | RECEIVED | |
| CHECKED | REVISED AS BUILT | |
| ALL WORK SHALL BE DONE IN ACCORDANCE WITH THE CITY OF SEATTLE STANDARD PLANS AND SPECIFICATIONS AND OTHER DOCUMENTS CALLED FOR IN SECTION 0-02.3 OF THE PROJECT MANUAL. | | |

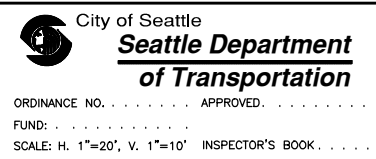
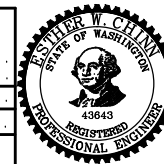

F:\STDrfter\2015_AAC\Roosevelt\A_PLOT FILES\TS6067A-P-N100.dwg
May-23-14 8:44am

GENERAL NOTES

- FOR REQUIREMENTS REGARDING THE PROTECTION AND RESTORATION OF PUBLIC AND PRIVATE PROPERTY SEE SECTIONS 1-07.16 & 1-07.17.
- UNDER NO CIRCUMSTANCES SHALL WORK BE PERFORMED WHICH WOULD REMOVE, ADJUST, DESTROY OR OTHERWISE MAKE A SURVEY MONUMENT NO LONGER VISIBLE OR READILY ACCESSIBLE WITHOUT A PERMIT FROM THE WASHINGTON STATE DEPARTMENT OF NATURAL RESOURCES. SEE SECTION 1-07.16(1).
- TREES, SHRUBS AND OTHER PLANT MATERIAL NOT DESIGNATED FOR REMOVAL SHALL BE PROTECTED FROM DAMAGE. SEE SECTION 1-07.16(2).
- RESTORATION OF CONTRACTOR DAMAGE TO EXISTING UTILITIES SHALL BE AT THE CONTRACTOR'S EXPENSE. SEE SECTIONS 1-07.13 AND 1-07.16.
- THE CONTRACTOR SHALL NOTIFY THE UTILITIES FOR UNDERGROUND UTILITY LOCATIONS BEFORE COMMENCEMENT OF ANY EXCAVATION. ADVANCE NOTIFICATION IS REQUIRED. SEE SECTION 1-07.28.
- PUBLIC UTILITY REPLACEMENT, CASTINGS AND COVERS WILL BE PROVIDED BY THE OWNER(S) OF THE UTILITIES. THE CONTRACTOR SHALL ADJUST ALL UTILITY CASTINGS AND WATER METER BOXES TO FINAL GRADE. SEE SECTION 7-20.3.
- FOR NOTIFICATION AND COORDINATION REQUIREMENTS, INCLUDING COMMUNICATION WITH METRO TRANSIT, SEE SECTION 1-07.28.

ROADWAY NOTES

UNLESS OTHERWISE NOTED ON THE DRAWINGS:

- PAVEMENT, SIDEWALK AND CURB REMOVALS SHALL EXTEND TO EXISTING JOINTS, TO LIMITS IDENTIFIED BY "SAW" ON THE DRAWINGS, OR TO LIMITS DETERMINED BY THE ENGINEER. SEE SECTION 2-02.3.
- THE ENGINEER WILL DIRECT THE LOCATIONS OF PRELEVELING. SEE SECTION 5-04.3(4)B2.
- ALL JOINTS AT THE MEET LINES OF NEW CONSTRUCTION AND EXISTING SURFACES SHALL BE BUTT JOINTS. SEE SECTION 5-04.3(10)B.
- LONGITUDINAL PAVING JOINTS SHALL BE COORDINATED WITH THE CHANNELIZATION DRAWINGS. LONGITUDINAL JOINTS IN THE TOP LAYER SHALL BE AT A LANE LINE OR EDGE LINE OF THE TRAVELED WAY UNLESS OTHERWISE APPROVED IN WRITING BY THE ENGINEER. SEE SECTION 5-04.3(10)A.
- PRIOR TO SAWCUT AND REMOVAL FOR BASE REPAIR, THE CONTRACTOR SHALL HAVE THE LIMITS VERIFIED BY THE ENGINEER.
- HMA SURFACE COURSE SHALL BE CLASS ½", PG 70-22 FOR 10 MILLION ESAL'S.

DRAINAGE NOTES

UNLESS OTHERWISE NOTED ON THE DRAWINGS:

- FOR INLET CONNECTION BEND AND SLOPE RESTRICTIONS, SEE SECTION 7-08.3(5). CATCH BASIN CONNECTION SHALL BE 2% MINIMUM SLOPE.
- WHEN CONNECTING TO EXISTING SEWER AND DRAINAGE LINES, THE CONTRACTOR SHALL VERIFY INVERT ELEVATIONS PRIOR TO CONSTRUCTION. DISCREPANCIES IN INVERT ELEVATIONS SHALL BE IMMEDIATELY BROUGHT TO THE ATTENTION OF THE ENGINEER.
- DUCTILE IRON PIPE BEDDING SHALL BE CLASS D. SEE SECTION 7-08.3(5), 7-17.5 AND STD PLAN 285.
- ALL INLET AND CATCH BASIN PIPE RECONNECTION SHALL BE MISSION FLEX-SEAL ARC (WWW.MISSIONRUBBER.COM) OR APPROVED EQUAL. SEE SECTIONS 7-08.3(5) AND 7-08.5.
- SEATTLE PUBLIC UTILITIES (SPU) APPROVAL REQUIRED FOR ALL PROPOSE NEW CATCH BASIN, INLET AND PIPES PRIOR TO FINAL PAVMNT RESTORATION.

SIGNAL & LIGHTING NOTES

UNLESS OTHERWISE NOTED ON THE DRAWINGS:

- THE CONTRACTOR SHALL IMMEDIATELY REPORT ANY DAMAGE TO THE TRAFFIC SIGNAL SYSTEM, INCLUDING CONDUIT AND THE DETECTOR LOOPS. SEE SECTION 1-07.28 NOTE 16.
- THE TRAFFIC SIGNAL SYSTEM INTERCONNECT CABLE AND SIGNAL WIRE SERVICE, VIDEO, OR MASTER CABLE SHALL NOT BE SPLICED. SEE SECTIONS 8-31.3(8)A AND 8-31.3(9)B.
- THE CONTRACTOR SHALL CONTACT SDOT TRAFFIC SIGNAL OPERATIONS WHEN THE TRAFFIC SIGNAL SYSTEMS OR THE TRAFFIC DETECTOR LOOPS MAY BE IMPACTED BY CONSTRUCTION. ADVANCE NOTIFICATION IS REQUIRED. SEE SECTION 1-07.28, SIGNALIZED INTERSECTIONS.
- THE CONTRACTOR SHALL PROVIDE PRELIMINARY LAYOUT FOR THE TRAFFIC DETECTOR LOOPS. THE LAYOUT SHALL BE VERIFIED BY THE ENGINEER PRIOR TO SAW CUTTING. ADVANCE NOTIFICATION IS REQUIRED. SEE SECTION 8-31.3(5)A.
- ALL LOOP DETECTOR AND LEAD-IN CABLES NOT SHOWN FOR REPLACEMENT SHALL BE PROTECTED DURING SIDEWALK AND PAVEMENT REMOVAL (INCLUDING PLANING.) SEE SECTION 2-02.3(1).

SIGNING & CHANNELIZATION NOTES

UNLESS OTHERWISE NOTED ON THE DRAWINGS:

- TO ORDER SDOT PROVIDED SIGNS, OR TO COORDINATE SDOT'S INSTALLATION OF SIGNS, SEE SECTION 8-21.3(1). ADVANCE NOTIFICATION IS REQUIRED.
- FOR REQUIREMENTS ON LAYOUT AND VERIFICATION OF CHANNELIZATION FEATURES, SEE SECTION 8-22.3(1). ADVANCE NOTIFICATION IS REQUIRED.

WATER POLLUTION PREVENTION & EROSION CONTROL NOTES

- THE CONTRACTOR SHALL PREPARE A STORMWATER POLLUTION PREVENTION PLAN (SWPPP), WHICH INCLUDES AS ELEMENTS THE TEMPORARY EROSION AND SEDIMENTATION CONTROL (TESC), AND THE SPILL PREVENTION, CONTROL AND COUNTERMEASURE (SPCC). SEE SECTION 1-07.15

NT1
NOTES

30% REVIEW
NOT FOR CONSTRUCTION
MAY 2014

APPROVED FOR ADVERTISING
NANCY LOCKE
DEPARTMENT OF FINANCE & ADMINISTRATIVE SERVICES
SEATTLE, WASHINGTON 20
BY: _____
PURCHASING & CONTRACTING SERVICES DIRECTOR

| | |
|---|-----------------------------------|
| NAME OR INITIALS AND DATE | INITIALS AND DATE |
| DESIGNED | REVIEWED: |
| CHECKED | DES. CONST. |
| | SDOT PROJ. MGR. |
| DRAWN | RECEIVED |
| CHECKED | REVISED AS BUILT |
| ALL WORK SHALL BE DONE IN ACCORDANCE WITH THE CITY OF SEATTLE STANDARD PLANS AND SPECIFICATIONS AND OTHER DOCUMENTS CALLED FOR IN SECTION 0-02.3 OF THE PROJECT MANUAL. | |

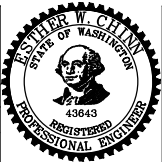

City of Seattle
**Seattle Department
of Transportation**
ORDINANCE NO. APPROVED.
FUND:
SCALE: H. 1"=20', V. 1"=10' INSPECTOR'S BOOK

2015 ARTERIAL ASPHALT
AND CONCRETE
ROOSEVELT WAY NE

| | | |
|-------------------------|-----|---------|
| CON JOB | PC | TA6067A |
| | R/W | |
| | CO | TA6067C |
| VAULT PLAN NO. ----- | | |
| SHEET 2 OF # | | |

\\STDRafter\2015_AAC\Roosevelt\A_PLOT FILES\TS6067A-P-ROAD.dwg
May-23-14 8:48am

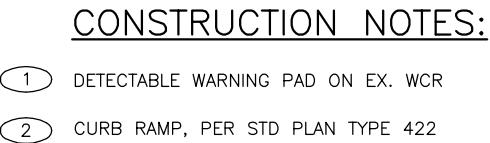

NOTE: THE BASEMAP IS A PERC MAP. THE PROJECT SURVEY WILL BE AVAILABLE AFTER 30% REVIEW.

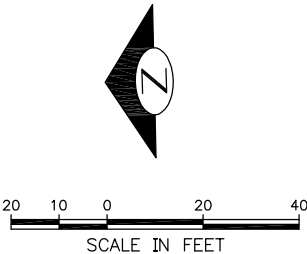

PV1
PAVING PLAN
ADDITIVE 1

| | | |
|----------------|-----|---------|
| JOB NO. | PC | TA6067A |
| | R/W | |
| | CO | TA6067C |
| VAULT PLAN NO. | | |
| ---- | | |
| SHEET 3 OF # | | |

30% REVIEW
NOT FOR CONSTRUCTION
MAY 2014

APPROVED FOR ADVERTISING
NANCY LOCKE
DEPARTMENT OF FINANCE & ADMINISTRATIVE SERVICES
SEATTLE, WASHINGTON 20

BY:
PURCHASING & CONTRACTING SERVICES DIRECTOR

| | | | |
|--|------|-------------------|------------|
| NAME OR INITIALS AND DATE | | INITIALS AND DATE | |
| DESIGNED | ---- | REVIEWED: | |
| CHECKED | ---- | DES. | CONST. |
| | | SDOT | PROJ. MGR. |
| DRAWN | | RECEIVED | |
| CHECKED | ---- | REVISED AS BUILT | |
| ALL WORK SHALL BE DONE IN ACCORDANCE WITH THE CITY OF SEATTLE STANDARD PLANS AND SPECIFICATIONS AND OTHER DOCUMENTS CALLED FOR IN SECTION 0-2.3 OF THE PROJECT MANUAL. | | | |

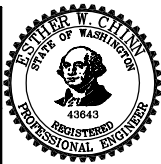

City of Seattle
***Seattle Department
of Transportation***

ORDINANCE NO. APPROVED.
FUND:
SCALE: H. 1"=20', V. 1"=10' INSPECTOR'S BOOK . . .

2015 ARTERIAL ASPHALT AND CONCRETE ROOSEVELT WAY NE

PAVING LEGEND:

- PAVEMENT, 2" HMA CL 1/2" OVERLAY (PLANE 2" EX. ASPHALT OR TO EX. CONC), SEE PAVEMENT SECTION ON SHT PV6
- PAVEMENT, 2" HMA CL 1/2" OVER 10" CONC BASE OEVR 6" MNRL AGG TYPE 2
- CEM CONC DRIVEWAY TYPE 430 (REM CW OR CONC PAVEMENT)
- SIDEWALK CEM CONC, W/25% POZZOLANS PER STD PLANS 420 OR 421. (SAWCUT & REMOVE EX. CW)
- CURB TYPE 410C, CEM CONC, W/25% POZZOLANS
- SAW RIGID PAVEMENT, FULL DEPTH

CONSTRUCTION NOTES:

- 1 DETECTABLE WARNING PAD ON EX. WCR
- 2 CURB RAMP, PER STD PLAN TYPE 422
- 3 NOT USE
- 4 TRIM HEDGES
- 5 REMOVE TREE
- 6 PIPE, INLET CONNECTION, DIP CL50, 8"
- 7 PIPE, CB CONNECTION, DIP CL50, 8"
- 8 CORE DRILL BY SPU

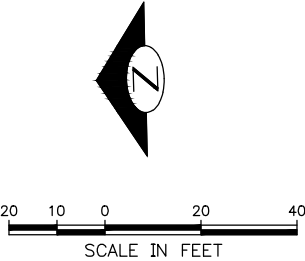

PV2
PAVING PLAN
ADDITIVE 1

2015 ARTERIAL ASPHALT
AND CONCRETE
ROOSEVELT WAY NE

| | |
|----------------|---------|
| PC | TA6067A |
| R/W | |
| CO | TA6067C |
| Vault Plan No. | |
| SHEET | 4 OF # |

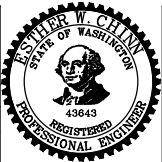

City of Seattle
**Seattle Department
of Transportation**

ORDINANCE NO. APPROVED.

FUND:

SCALE: H. 1"=20', V. 1"=10' INSPECTOR'S BOOK.

| NAME OR INITIALS AND DATE | INITIALS AND DATE |
|---|-----------------------------------|
| DESIGNED | REVIEWED: |
| CHECKED | DES. CONST. |
| | SDOT PROJ. MGR. |
| DRAWN | RECEIVED |
| CHECKED | REVISED AS BUILT |
| ALL WORK SHALL BE DONE IN ACCORDANCE WITH THE CITY OF SEATTLE STANDARD PLANS AND SPECIFICATIONS AND OTHER DOCUMENTS CALLED FOR IN SECTION 0-02.3 OF THE PROJECT MANUAL. | |

APPROVED FOR ADVERTISING
NANCY LOCKE
DEPARTMENT OF FINANCE & ADMINISTRATIVE SERVICES
SEATTLE, WASHINGTON 20

BY:
PURCHASING & CONTRACTING SERVICES DIRECTOR

30% REVIEW
NOT FOR CONSTRUCTION
MAY 2014

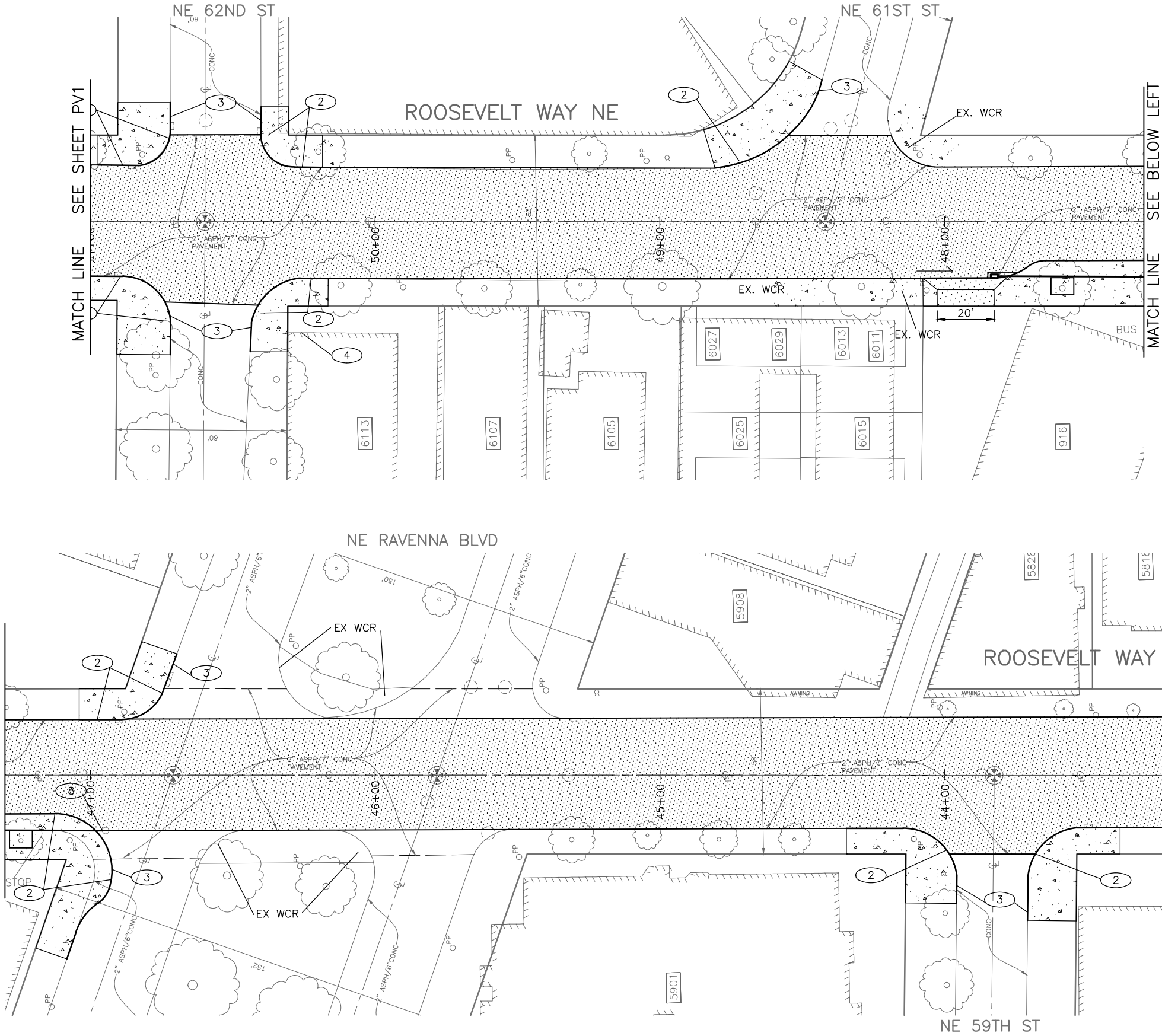

| VAULT SERIAL NO. | DATE | MARK | NATURE | MADE CHKD REV'D |
|------------------|------|------|--------|-----------------|
| | | | | |
| | | | | |
| | | | | |
| | | | | |

PAVING LEGEND:

- PAVEMENT, 2" HMA CL 1/2" OVERLAY (PLANE 2" EX. ASPHALT OR TO EX. CONC), SEE PAVEMENT SECTION ON SHT PV6
- PAVEMENT, 2" HMA CL 1/2" OVER 10" CONC BASE OEVR 6" MNRL AGG TYPE 2
- CEM CONC DRIVEWAY TYPE 430 (REM CW OR CONC PAVEMENT)
- SIDEWALK CEM CONC, W/25% POZZOLANS PER STD PLANS 420 OR 421. (SAWCUT & REMOVE EX. CW)
- CURB TYPE 410C, CEM CONC, W/25% POZZOLANS
- SAW RIGID PAVEMENT, FULL DEPTH

CONSTRUCTION NOTES:

- 1 DETECTABLE WARNING PAD ON EX. WCR
- 2 CURB RAMP, PER STD PLAN TYPE 422
- 3 NOT USE
- 4 TRIM HEDGES
- 5 REMOVE TREE
- 6 PIPE, INLET CONNECTION, DIP CL50, 8"
- 7 PIPE, CB CONNECTION, DIP CL50, 8"
- 8 CORE DRILL BY SPU



PV3
PAVING PLAN
ADDITIVE 1

2015 ARTERIAL ASPHALT
AND CONCRETE
ROOSEVELT WAY NE

| | |
|----------------|---------|
| PC | TA6067A |
| R/W | |
| CO | TA6067C |
| Vault Plan No. | |
| SHEET | 5 OF # |

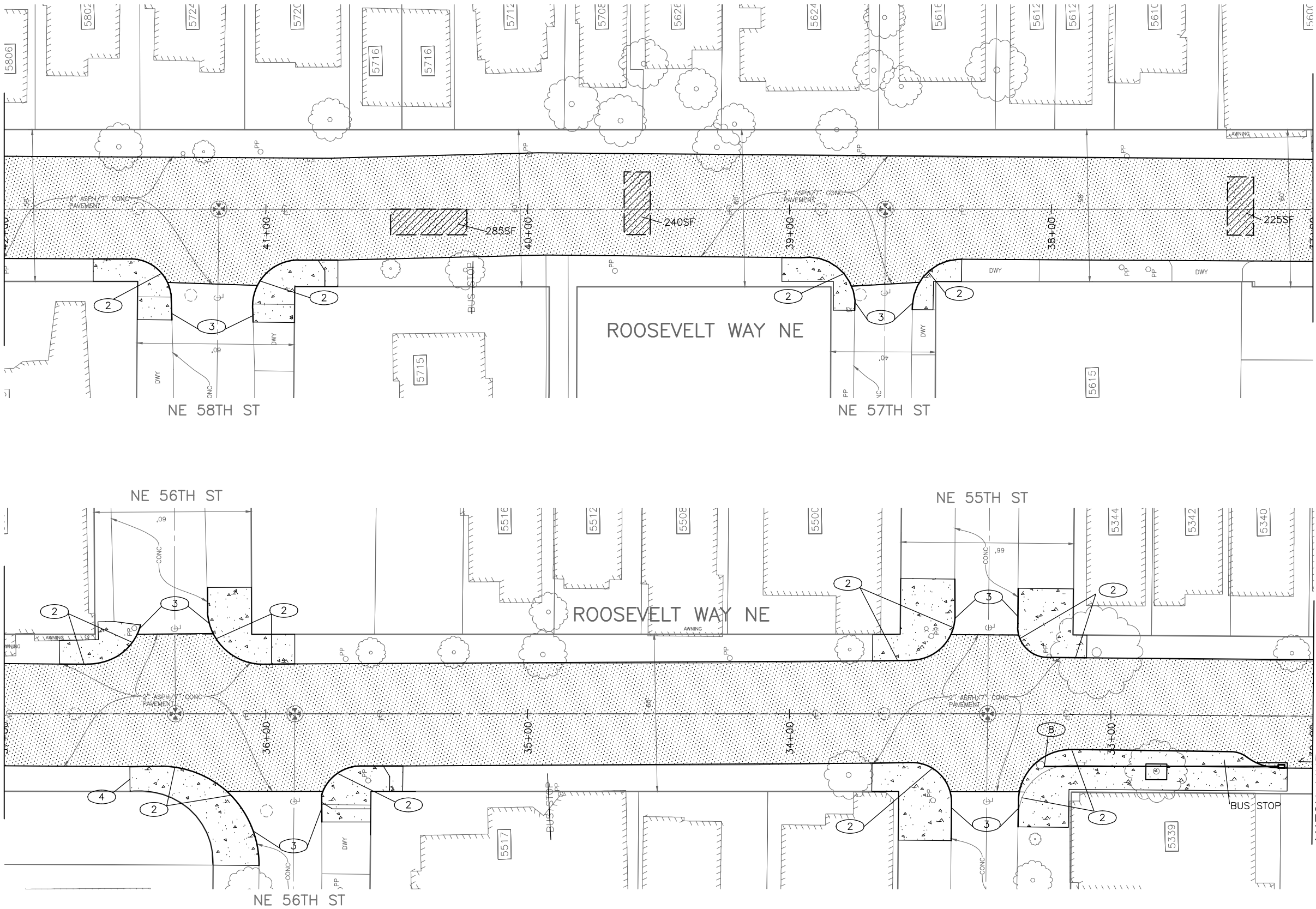

30% REVIEW
NOT FOR CONSTRUCTION
MAY 2014

APPROVED FOR ADVERTISING
NANCY LOCKE
DEPARTMENT OF FINANCE & ADMINISTRATIVE SERVICES
SEATTLE, WASHINGTON 20
BY: PURCHASING & CONTRACTING SERVICES DIRECTOR

| NAME OR INITIALS AND DATE | INITIALS AND DATE |
|---|-----------------------------------|
| DESIGNED | REVIEWED: |
| CHECKED | DES. CONST. |
| | SDOT PROJ. MGR. |
| DRAWN | RECEIVED |
| CHECKED | REVISED AS BUILT |
| ALL WORK SHALL BE DONE IN ACCORDANCE WITH THE CITY OF SEATTLE STANDARD PLANS AND SPECIFICATIONS AND OTHER DOCUMENTS CALLED FOR IN SECTION 0-02.3 OF THE PROJECT MANUAL. | |

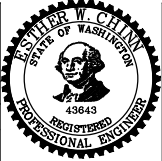

City of Seattle
**Seattle Department
of Transportation**
ORDINANCE NO. APPROVED.
FUND:
SCALE: H. 1"=20', V. 1"=10' INSPECTOR'S BOOK.

\\STDRafter\2015_AAC\Roosevelt\A_PLOT_FILES\TS6067A-P-ROAD.dwg
May-23-14 8:45am

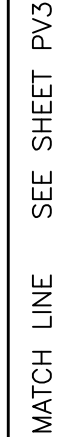

MATCH LINE SEE ABOVE RIGHT

MATCH LINE SEE BELOW LEFT



| | | |
|-------------------------|-----|---------|
| JOB NO. | PC | TA6067A |
| | R/W | |
| | CO | TA6067C |
| VAULT PLAN NO. ----- | | |
| SHEET 6 OF # | | |

30% REVIEW
NOT FOR CONSTRUCTION
MAY 2014

APPROVED FOR ADVERTISING
NANCY LOCKE
DEPARTMENT OF FINANCE & ADMINISTRATIVE SERVICES
SEATTLE, WASHINGTON 20

BY: _____
PURCHASING & CONTRACTING SERVICES DIRECTOR

| | | | |
|--|--|-------------------|--------------------|
| NAME OR INITIALS AND DATE | | INITIALS AND DATE | |
| DESIGNED | | REVIEWED: | |
| CHECKED | | DES. | CONST. |
| | | SDOT | PROJ. MGR. |
| DRAWN | | RECEIVED | |
| CHECKED | | REVISED AS BUILT | |
| ALL WORK SHALL BE DONE IN ACCORDANCE WITH THE CITY OF SEATTLE STANDARD PLANS AND SPECIFICATIONS AND OTHER DOCUMENTS CALLED FOR IN SECTION 0-2.3 OF THE PROJECT MANUAL. | | | |

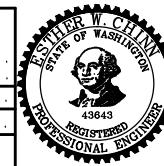



City of Seattle

Seattle Department

of Transportation

ORDINANCE NO.

APPROVED.

FUND:

SCALE: H. 1"=20', V. 1"=10'

INSPECTOR'S BOOK.

C:\STDraft\2015_AAC\Roosevelt\A_PLOT FILES\TS6067A-P-ROAD.dwg
 May-23-14 8:45am

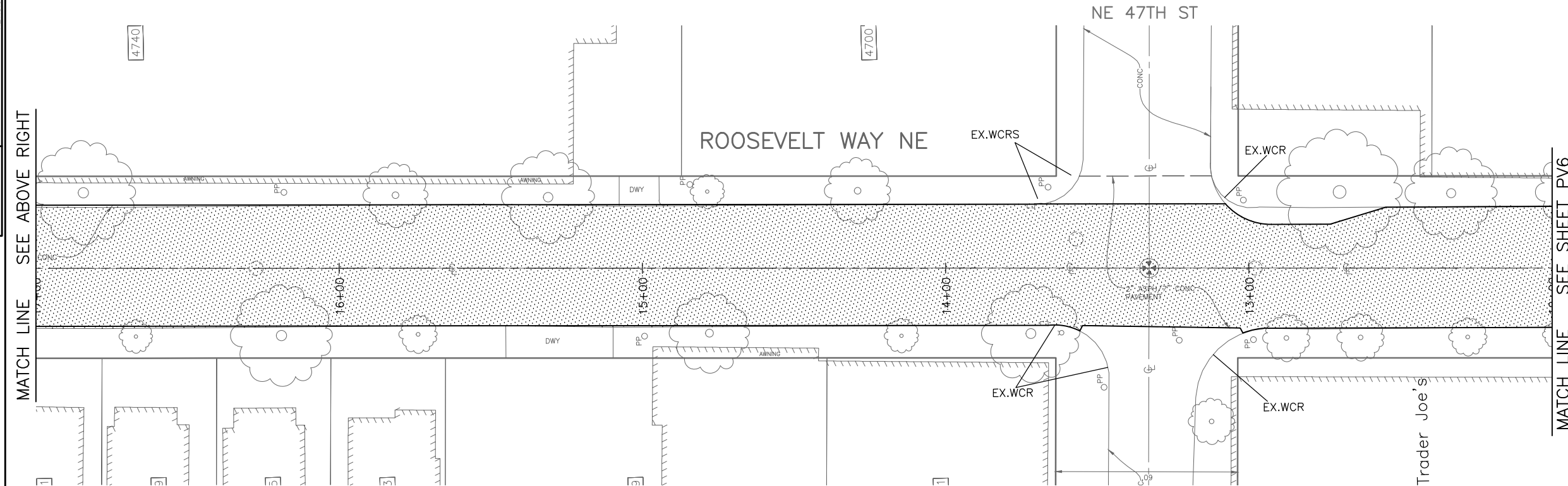

① DETECTABLE WARNING PAD ON EX. WCR

② CURB RAMP, PER STD PLAN TYPE 422

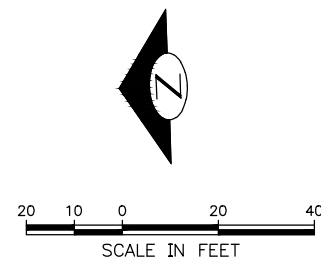

PV5
PAVING PLAN
ADDITIVE 1

30% REVIEW
NOT FOR CONSTRUCTION
MAY 2014

APPROVED FOR ADVERTISING
NANCY LOCKE
DEPARTMENT OF FINANCE & ADMINISTRATIVE SERVICES
SEATTLE, WASHINGTON 20

By: _____
PURCHASING & CONTRACTING SERVICES DIRECTOR

| | | | |
|---|--|-------------------|--------------------|
| NAME OR INITIALS AND DATE | | INITIALS AND DATE | |
| DESIGNED | | REVIEWED: | |
| CHECKED | | DES. | CONST. |
| | | SDOT | PROJ. MGR. |
| DRAWN | | RECEIVED | |
| CHECKED | | REVISED AS BUILT | |
| ALL WORK SHALL BE DONE IN ACCORDANCE WITH THE CITY OF SEATTLE STANDARD PLANS AND SPECIFICATIONS AND OTHER DOCUMENTS CALLED FOR IN SECTION 0-02.3 OF THE PROJECT MANUAL. | | | |

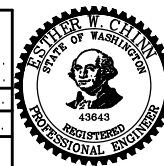



City of Seattle

Seattle Department

of Transportation

ORDINANCE NO.

FUND:

SCALE: H. 1"=20', V. 1"=10'

APPROVED.

INSPECTOR'S BOOK.

2015 ARTERIAL ASPHALT
AND CONCRETE
ROOSEVELT WAY NE

| | | |
|-------------------------|-----|---------|
| JOB NO. | PC | TA6067A |
| | R/W | |
| | CO | TA6067C |
| VAULT PLAN NO. ----- | | |
| SHEET 7 OF # | | |

I:\STDDrafter\2015_AAC\Roosevelt\A_PLOT FILES\TS6067A-P-ROAD.dwg
 May-23-14 8:45am

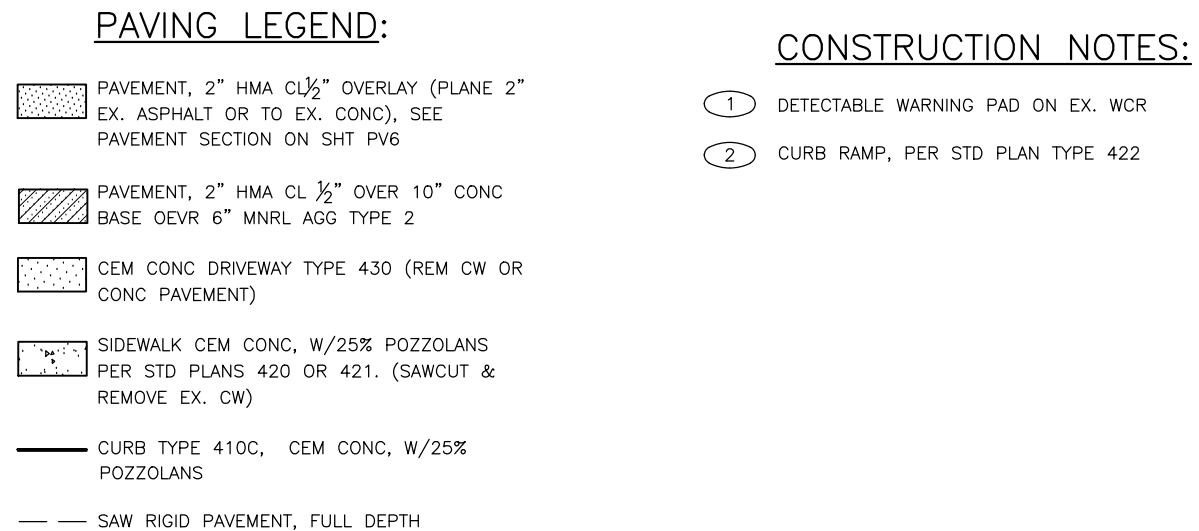

- ## SECTION NOTES:
- 1 PLANE 2" ASPHALT PAVEMENT OR TO EXISTING CONCRETE
 - 2 PAVE 2" HMA CL ½"
 - 4 REMOVE EX CONC CURB
 - 5 REMOVE EXISTING CEM CONC SIDEWALK
 - 6 CEM CONC SIDEWALK TYPE 420
 - 7 CEM CONC CURB TYPE 410C

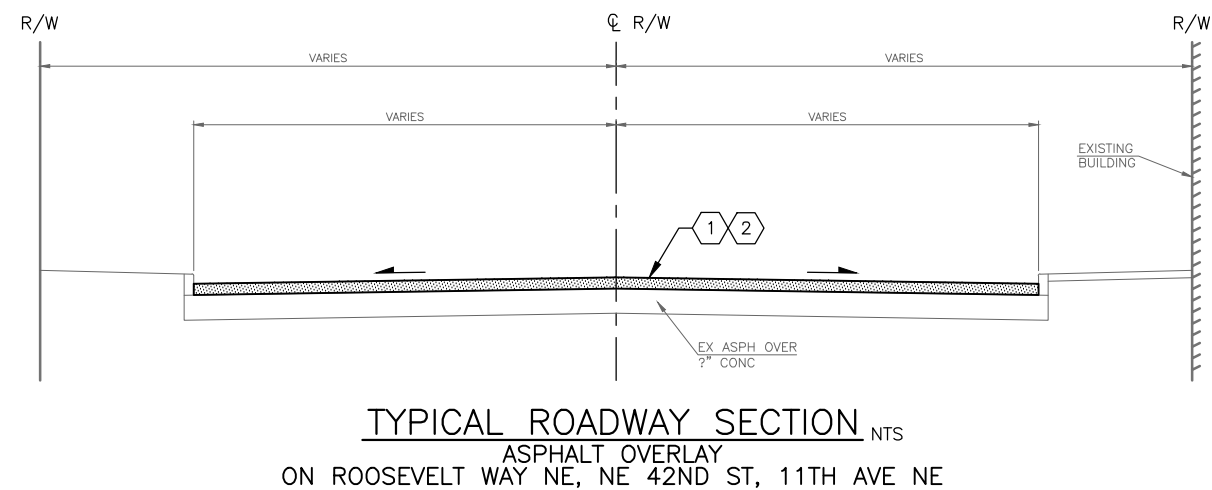

PV6
PAVING PLAN
ADDITIVE 1

30% REVIEW
NOT FOR CONSTRUCTION
MAY 2014

APPROVED FOR ADVERTISING
NANCY LOCKE
DEPARTMENT OF FINANCE & ADMINISTRATIVE SERVICES
SEATTLE, WASHINGTON 20

By: _____
PURCHASING & CONTRACTING SERVICES DIRECTOR

| | | | |
|---|--|-------------------|--------------------|
| NAME OR INITIALS AND DATE | | INITIALS AND DATE | |
| DESIGNED | | REVIEWED: | |
| CHECKED | | DES. | CONST. |
| | | SDOT | PROJ. MGR. |
| DRAWN | | RECEIVED | |
| CHECKED | | REVISED AS BUILT | |
| ALL WORK SHALL BE DONE IN ACCORDANCE WITH THE CITY OF SEATTLE STANDARD PLANS AND SPECIFICATIONS AND OTHER DOCUMENTS CALLED FOR IN SECTION 0-02.3 OF THE PROJECT MANUAL. | | | |

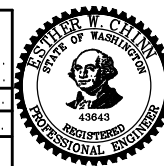



City of Seattle

Seattle Department

of Transportation

ORDINANCE NO.

APPROVED.

FUND:

SCALE: H. 1"=20', V. 1"=10'

INSPECTOR'S BOOK.

2015 ARTERIAL ASPHALT
AND CONCRETE
ROOSEVELT WAY NE

| | | |
|----------------|-----|---------|
| JOB NO. | PC | TA6067A |
| | R/W | |
| | CO | TA6067C |
| VAULT PLAN NO. | | |
| ---- | | |
| SHEET 8 OF # | | |

PAVING LEGEND:

- PAVEMENT, 2" HMA CL 1/2" OVERLAY (PLANE 2" EX. ASPHALT OR TO EX. CONC), SEE PAVEMENT SECTION ON SHT PV6
- PAVEMENT, 2" HMA CL 1/2" OVER 10" CONC BASE OEVR 6" MNRL AGG TYPE 2
- CEM CONC DRIVEWAY TYPE 430 (REM CW OR CONC PAVEMENT)
- SIDEWALK CEM CONC, W/25% POZZOLANS PER STD PLANS 420 OR 421. (SAWCUT & REMOVE EX. CW)
- CURB TYPE 410C, CEM CONC, W/25% POZZOLANS
- SAW RIGID PAVEMENT, FULL DEPTH

CONSTRUCTION NOTES:

- 1 DETECTABLE WARNING PAD ON EX. WCR
- 2 CURB RAMP, PER STD PLAN TYPE 422
- 3 NOT USE
- 4 TRIM HEDGES
- 5 REMOVE TREE
- 6 PIPE, INLET CONNECTION, DIP CL50, 8"
- 7 PIPE, CB CONNECTION, DIP CL50, 8"
- 8 CORE DRILL BY SPU

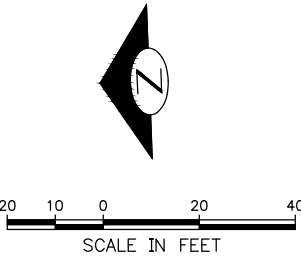

PV7
PAVING PLAN
BASE BID

2015 ARTERIAL ASPHALT
AND CONCRETE
ROOSEVELT WAY NE

| | | |
|--|----------------|---------|
| CITY OF SEATTLE DEPARTMENT OF TRANSPORTATION | PC | TA6067A |
| | R/W | |
| | CO | TA6067C |
| | Vault Plan No. | |
| SHEET 9 OF # | | |

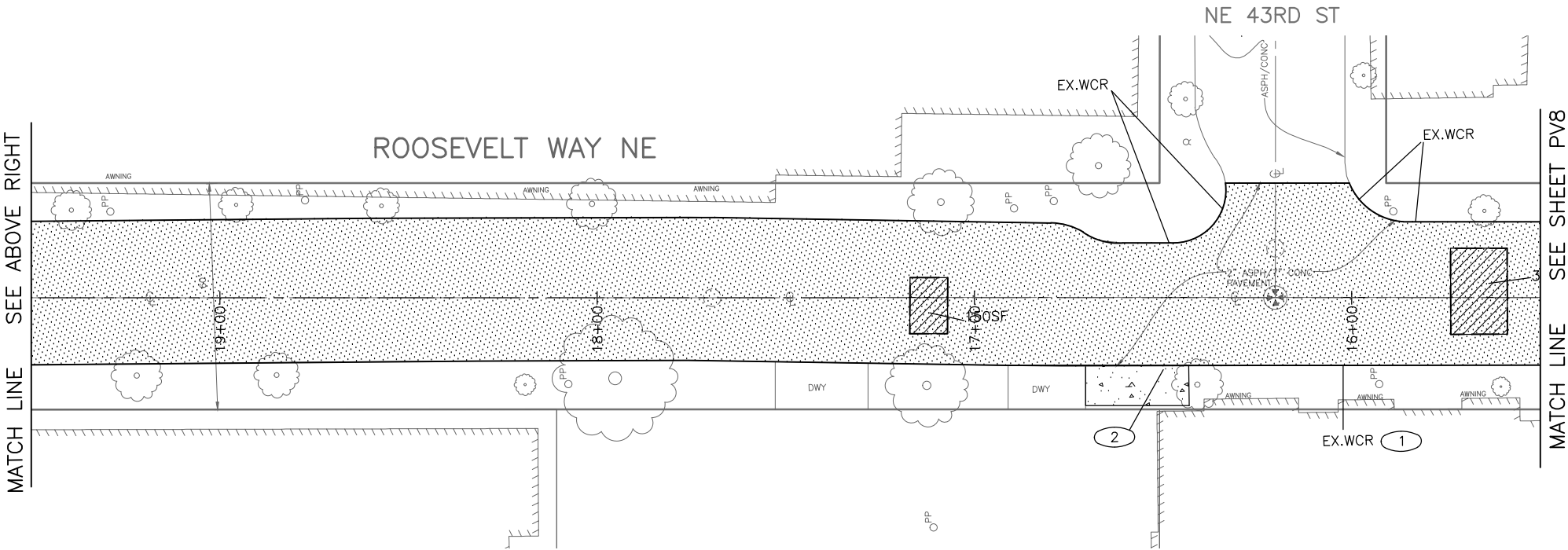
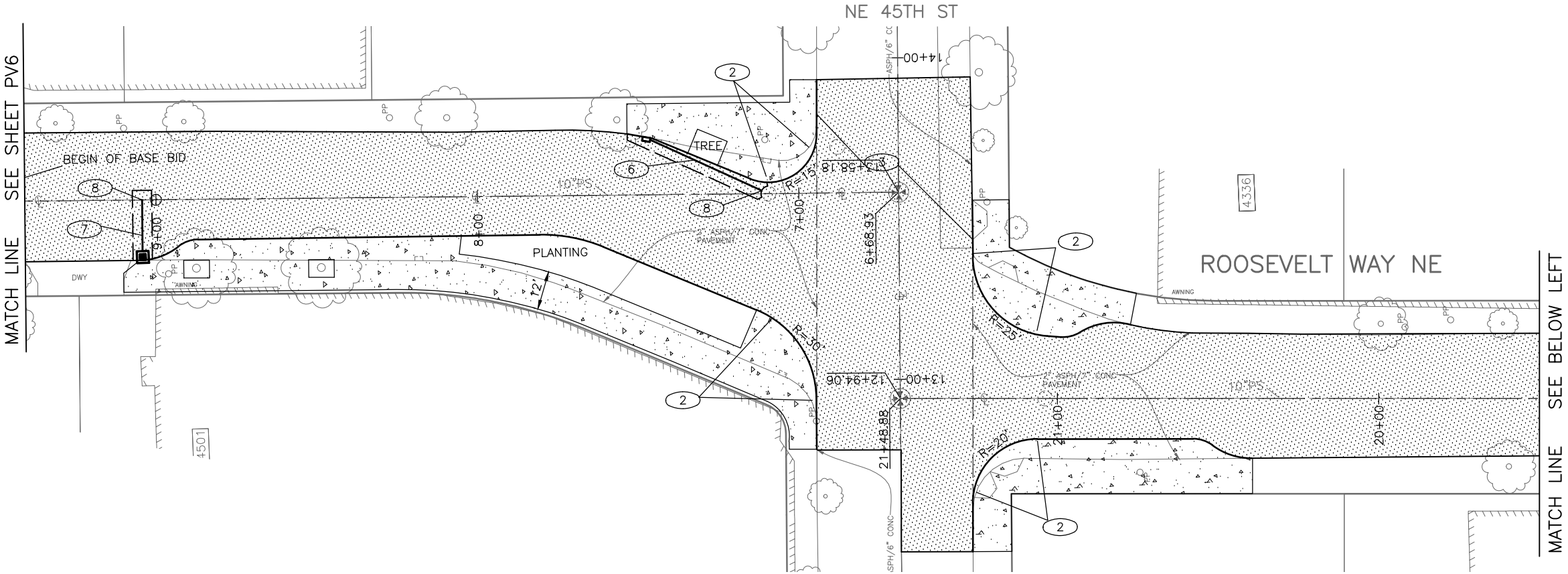

30% REVIEW
NOT FOR CONSTRUCTION
MAY 2014

APPROVED FOR ADVERTISING
NANCY LOCKE
DEPARTMENT OF FINANCE & ADMINISTRATIVE SERVICES
SEATTLE, WASHINGTON 20
BY: PURCHASING & CONTRACTING SERVICES DIRECTOR

| NAME OR INITIALS AND DATE | INITIALS AND DATE |
|---|-----------------------------------|
| DESIGNED | REVIEWED: |
| CHECKED | DES. CONST. |
| | SDOT PROJ. MGR. |
| DRAWN | RECEIVED |
| CHECKED | REVISED AS BUILT |
| ALL WORK SHALL BE DONE IN ACCORDANCE WITH THE CITY OF SEATTLE STANDARD PLANS AND SPECIFICATIONS AND OTHER DOCUMENTS CALLED FOR IN SECTION 0-02.3 OF THE PROJECT MANUAL. | |

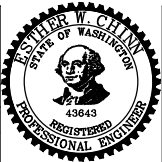

City of Seattle
**Seattle Department
of Transportation**
ORDINANCE NO. APPROVED.
FUND:
SCALE: H. 1"=20', V. 1"=10' INSPECTOR'S BOOK.

| VAULT SERIAL NO. | DATE | MARK | NATURE | MADE CHKD | REV'D |
|------------------|------|------|-----------|-----------|-------|
| ---- | ---- | ---- | REVISIONS | | |

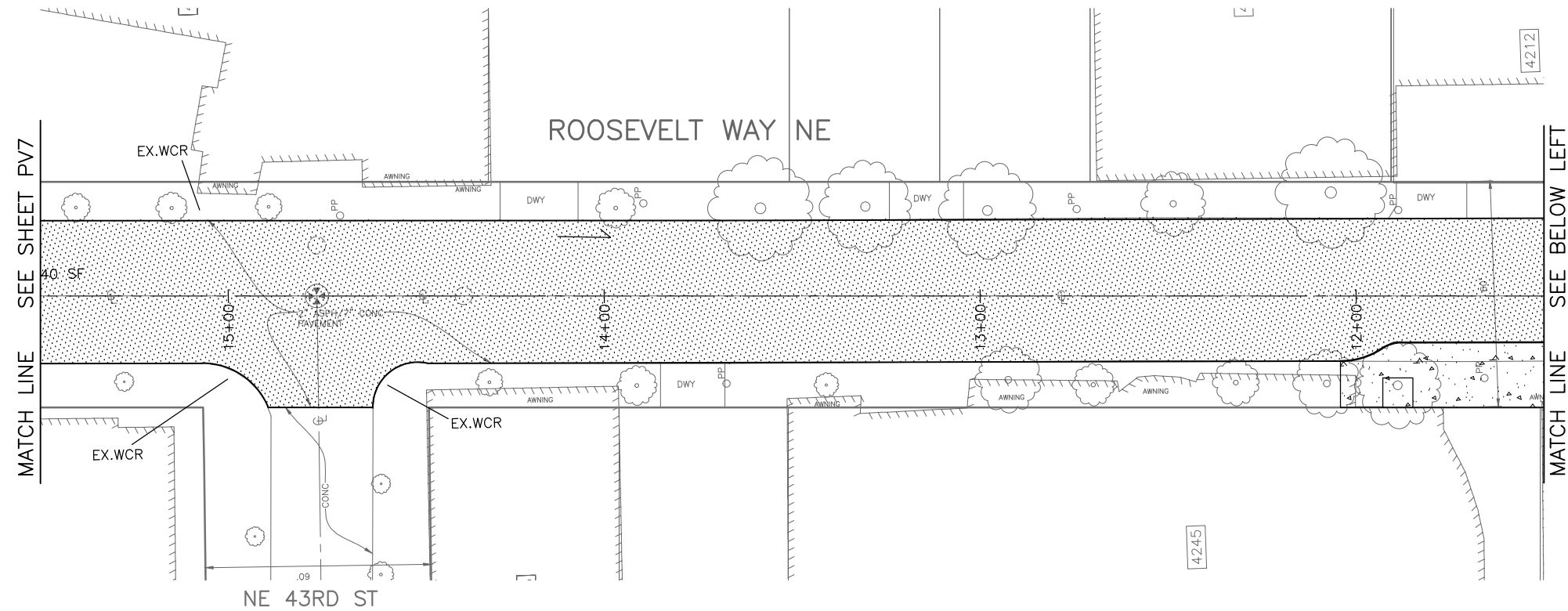

PAVING LEGEND:

- PAVEMENT, 2" HMA CL 1/2" OVERLAY (PLANE 2" EX. ASPHALT OR TO EX. CONC), SEE PAVEMENT SECTION ON SHT PV6
- PAVEMENT, 2" HMA CL 1/2" OVER 10" CONC BASE OEVR 6" MNRL AGG TYPE 2
- CEM CONC DRIVEWAY TYPE 430 (REM CW OR CONC PAVEMENT)
- SIDEWALK CEM CONC, W/25% POZZOLANS PER STD PLANS 420 OR 421. (SAWCUT & REMOVE EX. CW)
- CURB TYPE 410C, CEM CONC, W/25% POZZOLANS
- SAW RIGID PAVEMENT, FULL DEPTH

CONSTRUCTION NOTES:

- 1 DETECTABLE WARNING PAD ON EX. WCR
- 2 CURB RAMP, PER STD PLAN TYPE 422

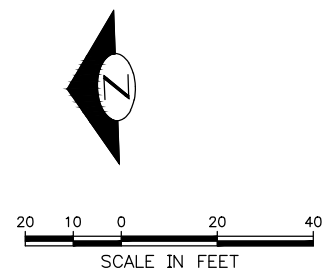
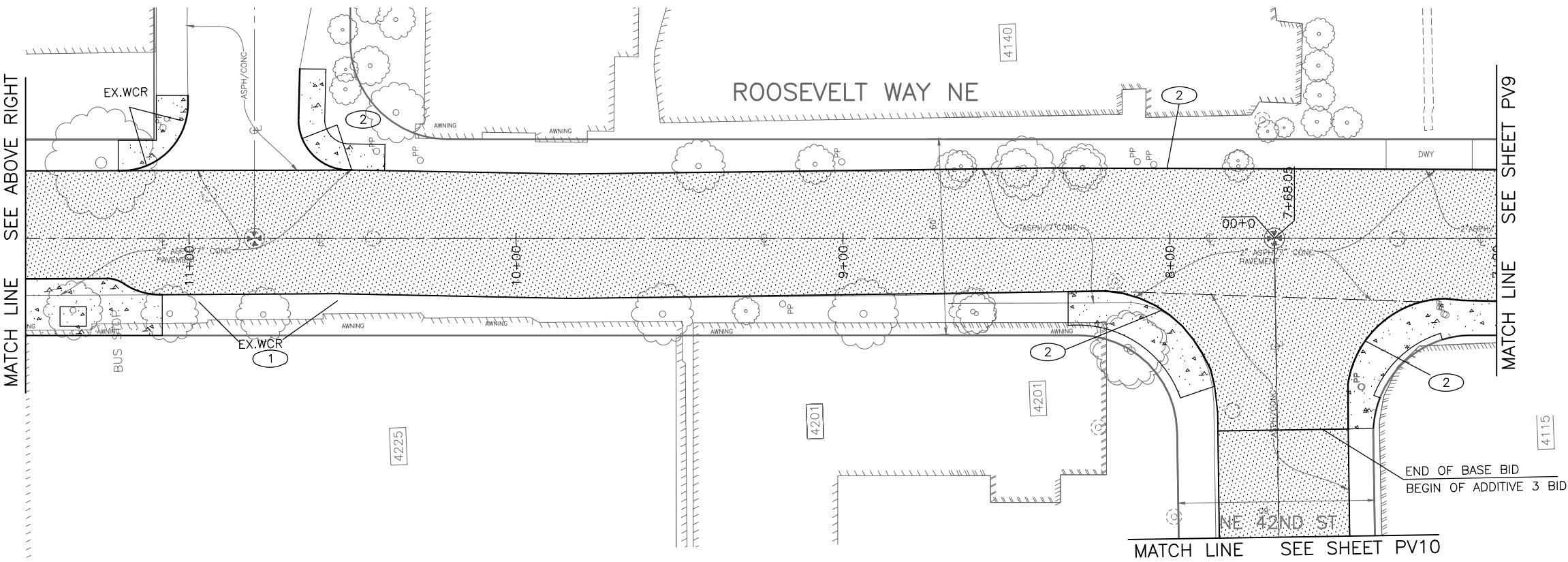

PV8
PAVING PLAN
BASE BID

30% REVIEW
NOT FOR CONSTRUCTION
MAY 2014

APPROVED FOR ADVERTISING
NANCY LOCKE
DEPARTMENT OF FINANCE & ADMINISTRATIVE SERVICES
SEATTLE, WASHINGTON 20
BY:
PURCHASING & CONTRACTING SERVICES DIRECTOR

| NAME OR INITIALS AND DATE | INITIALS AND DATE |
|---|-----------------------------------|
| DESIGNED | REVIEWED: |
| CHECKED | DES. CONST. |
| | SDOT PROJ. MGR. |
| DRAWN | RECEIVED |
| CHECKED | REVISED AS BUILT |
| ALL WORK SHALL BE DONE IN ACCORDANCE WITH THE CITY OF SEATTLE STANDARD PLANS AND SPECIFICATIONS AND OTHER DOCUMENTS CALLED FOR IN SECTION 0-02.3 OF THE PROJECT MANUAL. | |

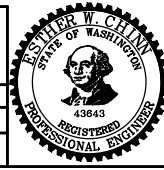

City of Seattle
Seattle Department of Transportation
ORDINANCE NO. APPROVED.
FUND:
SCALE: H. 1"=20', V. 1"=10' INSPECTOR'S BOOK

2015 ARTERIAL ASPHALT
AND CONCRETE
ROOSEVELT WAY NE

| | | |
|------------------------|-----|---------|
| CON | PC | TA6067. |
| NOB | R/W | |
| | CO | TA6067 |
| VAULT PLAN NO. | | |
| SHEET 10 OF # | | |

C:\STDraft\2015_AAC\Roosevelt\A_PLOT FILES\TS067A-P-ROAD.dwg
 May-23-14 8:45am

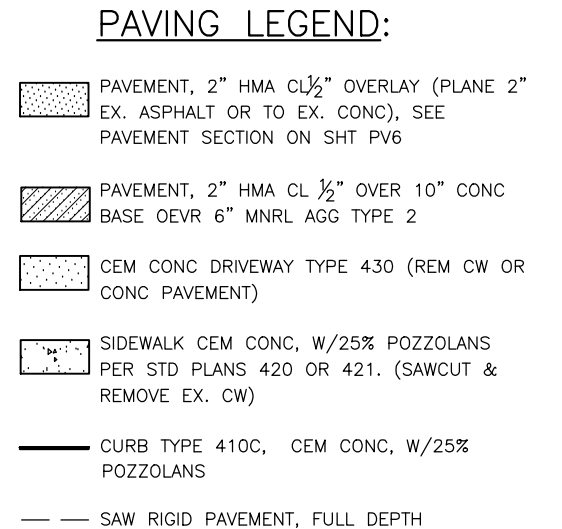

- ① DETECTABLE WARNING PAD ON EX. WCR
- ② CURB RAMP, PER STD PLAN TYPE 422





30% REVIEW
NOT FOR CONSTRUCTION
MAY 2014

APPROVED FOR ADVERTISING
NANCY LOCKE
DEPARTMENT OF FINANCE & ADMINISTRATIVE SERVICES
SEATTLE, WASHINGTON 20 . .

BY: _____
PURCHASING & CONTRACTING SERVICES DIRECTOR

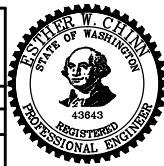
| | | | |
|---|-------|-------------------|------------|
| NAME OR INITIALS AND DATE | | INITIALS AND DATE | |
| DESIGNED | ----- | REVIEWED: | |
| CHECKED | ----- | DES. | CONST. |
| | | SDOT | PROJ. MGR. |
| DRAWN | | RECEIVED | |
| CHECKED | ----- | REVISED AS BUILT | |
| ALL WORK SHALL BE DONE IN ACCORDANCE WITH THE CITY OF SEATTLE STANDARD PLANS AND SPECIFICATIONS AND OTHER DOCUMENTS CALLED FOR IN SECTION 0-02.3 OF THE PROJECT MANUAL. | | | |





City of Seattle

Seattle Department

of Transportation

ORDINANCE NO.

APPROVED.

FUND:

INSPECTOR'S BOOK.

SCALE: H. 1"=20', V. 1"=10'

INSPECTOR'S BOOK.

| | | |
|--|---|-------------------|
| <div>2015 ARTERIAL ASPHALT AND CONCRETE ROOSEVELT WAY NE</div> | <div>JOB NO.</div> | PC TA6067A |
| | | R/W CO TA6067C |
| | <div>VAULT PLAN NO.</div> <div>----</div> | |
| <div>SHEET 11 OF #</div> | | |

D:\STDRafter\2015_AAC\Roosevelt\A_PLOT_FILES\TS6067A-P-ROAD.dwg
May-23-14 8:45am

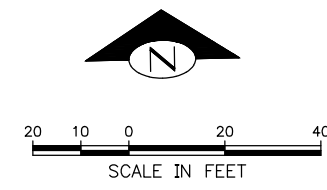

CONSTRUCTION NOTES:

PV10
PAVING PLAN
ADDITIVE 3

30% REVIEW
NOT FOR CONSTRUCTION
MAY 2014

APPROVED FOR ADVERTISING
NANCY LOCKE
DEPARTMENT OF FINANCE & ADMINISTRATIVE SERVICES
SEATTLE, WASHINGTON 20

BY: _____
PURCHASING & CONTRACTING SERVICES DIRECTOR

| | | |
|---|------------------------|------------------|
| NAME OR INITIALS AND DATE | INITIALS AND DATE | |
| DESIGNED _____ | REVIEWED: | |
| CHECKED _____ | DES. _____ | CONST. _____ |
| | SDOT _____ | PROJ. MGR. _____ |
| DRAWN _____ | RECEIVED _____ | |
| CHECKED _____ | REVISED AS BUILT _____ | |
| ALL WORK SHALL BE DONE IN ACCORDANCE WITH THE CITY OF SEATTLE STANDARD PLANS AND SPECIFICATIONS AND OTHER DOCUMENTS CALLED FOR IN SECTION 0-02.3 OF THE PROJECT MANUAL. | | |





City of Seattle

***Seattle Department
of Transportation***

ORDINANCE NO.

APPROVED.

FUND:

SCALE: H. 1"=20', V. 1"=10'

INSPECTOR'S BOOK.



2015 ARTERIAL ASPHALT
AND CONCRETE
ROOSEVELT WAY NE

| | | |
|-------------------------|-----|---------|
| JOB NO. | PC | TA6067A |
| | R/W | |
| | CO | TA6067C |
| VAULT PLAN NO. ----- | | |
| SHEET 12 OF # | | |

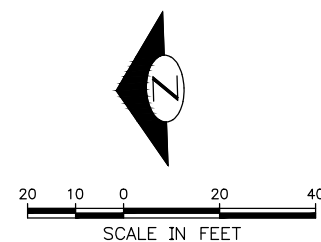
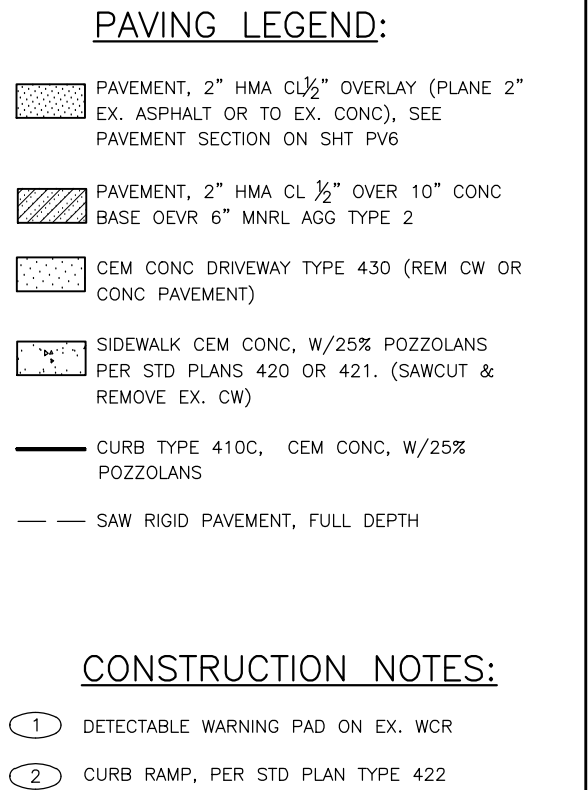
\\STDRafter\2015_AAC\Roosevelt\A_PLOT_FILES\TS6067A-P-ROAD.dwg
May-23-14 8:45am



PV11
PAVING PLAN
ADDITIVE 3

| | | | | | | | |
|--|--|---|--|---|--|---|---|
| <div style="border: 1px solid black; border-radius: 15px; padding: 5px; text-align: center;"> 30% REVIEW NOT FOR CONSTRUCTION MAY 2014 </div> | APPROVED FOR ADVERTISING NANCY LOCKE DEPARTMENT OF FINANCE & ADMINISTRATIVE SERVICES SEATTLE, WASHINGTON 20 | NAME OR INITIALS AND DATE DESIGNED _____ CHECKED _____ DRAWN _____ CHECKED _____ | INITIALS AND DATE REVIEWED: _____ DES. _____ CONST. _____ SDOT _____ PROJ. MGR. _____ RECEIVED _____ REVISED AS BUILT _____ |  |  City of Seattle <u>Seattle Department</u> <u>of Transportation</u> | <div style="text-align: center;"> <h1>2015 ARTERIAL ASPHALT AND CONCRETE ROOSEVELT WAY NE</h1> </div> | JOB NO. PC TA6067A R/W CO TA6067C VAULT PLAN NO. _____ |
| | BY: _____ PURCHASING & CONTRACTING SERVICES DIRECTOR | ALL WORK SHALL BE DONE IN ACCORDANCE WITH THE CITY OF SEATTLE STANDARD PLANS AND SPECIFICATIONS AND OTHER DOCUMENTS CALLED FOR IN SECTION 0-02.3 OF THE PROJECT MANUAL. | ORDINANCE NO. _____ APPROVED _____ FUND: _____ SCALE: H. 1"=20', V. 1"=10' INSPECTOR'S BOOK _____ | SHEET 13 OF # | | | |

May-23-14 8:45am
 C:\Users\user\Documents\2015_AAC\Roosevelt\A_PLOT_FILES\TS6067A-P-ROAD.dwg



30% REVIEW
NOT FOR CONSTRUCTION
MAY 2014

APPROVED FOR ADVERTISING
NANCY LOCKE
DEPARTMENT OF FINANCE & ADMINISTRATIVE SERVICES
SEATTLE, WASHINGTON 20

BY:
PURCHASING & CONTRACTING SERVICES DIRECTOR

| | | | |
|---------------------------|--|-------------------|--------------------|
| NAME OR INITIALS AND DATE | | INITIALS AND DATE | |
| DESIGNED | | REVIEWED: | |
| CHECKED | | DES. | CONST. |
| | | SDOT | PROJ. MGR. |
| DRAWN | | RECEIVED | |
| CHECKED | | REVISED AS BUILT | |

ALL WORK SHALL BE DONE IN ACCORDANCE WITH THE CITY OF SEATTLE STANDARD PLANS AND SPECIFICATIONS AND OTHER DOCUMENTS CALLED FOR IN SECTION 0-02.3 OF THE PROJECT MANUAL.

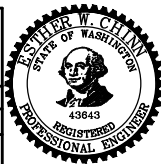



City of Seattle

Seattle Department

of Transportation

ORDINANCE NO.

APPROVED.

FUND:

INSPECTOR'S BOOK.

SCALE: H. 1"=20', V. 1"=10'

INSPECTOR'S BOOK.

2015 ARTERIAL ASPHALT AND CONCRETE ROOSEVELT WAY NE

| | | |
|-------------------------|-----|---------|
| JOB NO. | PC | TA6067A |
| | R/W | |
| | CO | TA6067C |
| VAULT PLAN NO. ----- | | |
| SHEET 14 OF # | | |

| VAULT SERIAL NO. | DATE | MARK | NATURE | MADE CHK'D | REV'D |
|------------------|------|------|--------|------------|-------|
| --- | | | | | |

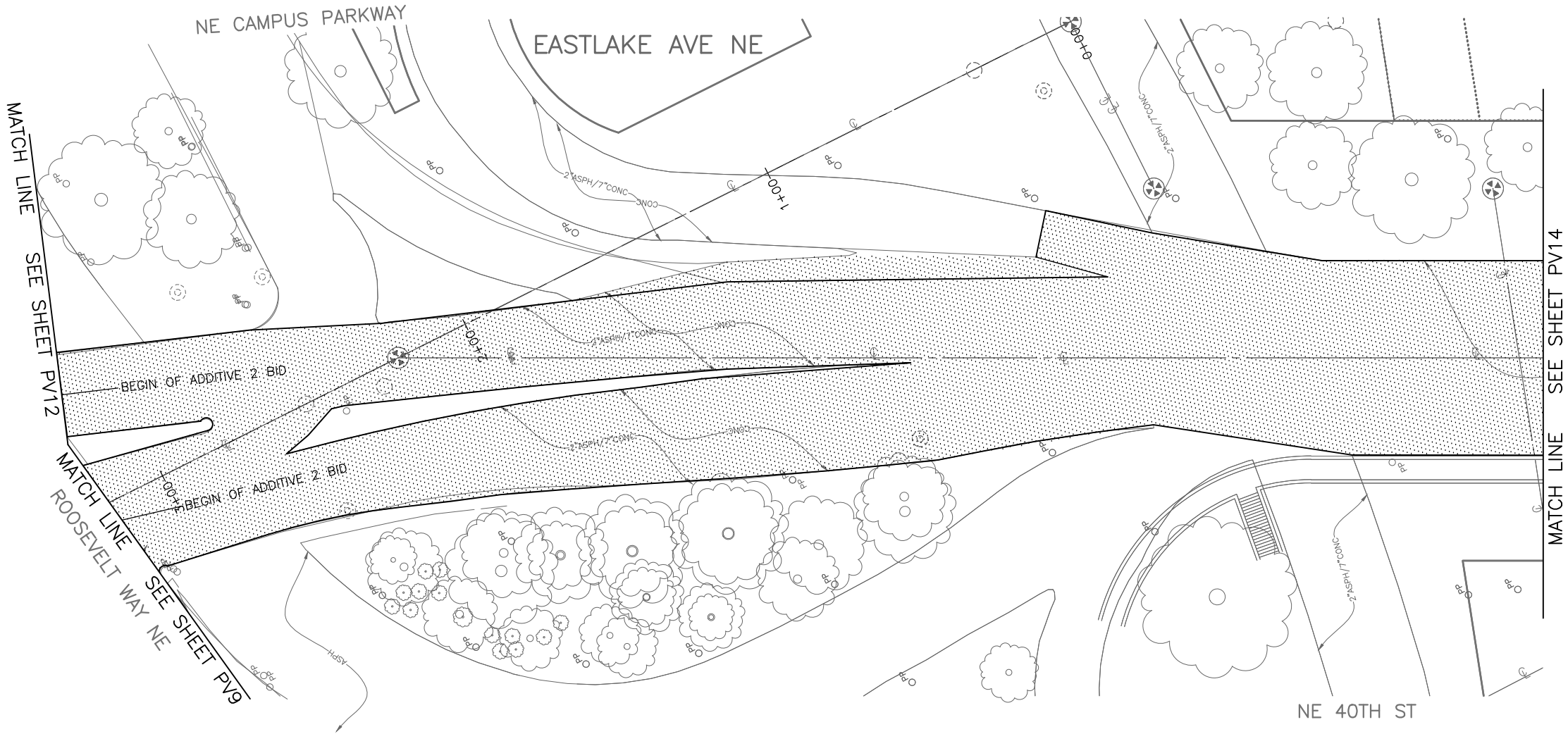

PAVING LEGEND:

- PAVEMENT, 2" HMA CL 1/2" OVERLAY (PLANE 2" EX. ASPHALT OR TO EX. CONC), SEE PAVEMENT SECTION ON SHT PV6
- PAVEMENT, 2" HMA CL 1/2" OVER 10" CONC BASE OEVR 6" MNRL AGG TYPE 2
- CEM CONC DRIVEWAY TYPE 430 (REM CW OR CONC PAVEMENT)
- SIDEWALK CEM CONC, W/25% POZZOLANS PER STD PLANS 420 OR 421. (SAWCUT & REMOVE EX. CW)
- CURB TYPE 410C, CEM CONC, W/25% POZZOLANS

CONSTRUCTION NOTES:

- 1 DETECTABLE WARNING PAD ON EX. WCR
- 2 CURB RAMP, PER STD PLAN TYPE 422

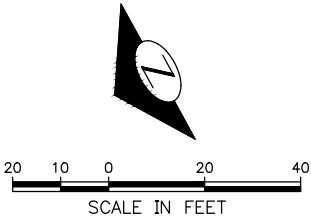

PV13
PAVING PLAN
ADDITIVE 2

30% REVIEW
NOT FOR CONSTRUCTION
MAY 2014

APPROVED FOR ADVERTISING
NANCY LOCKE
DEPARTMENT OF FINANCE & ADMINISTRATIVE SERVICES
SEATTLE, WASHINGTON 20
BY: PURCHASING & CONTRACTING SERVICES DIRECTOR

| NAME OR INITIALS AND DATE | INITIALS AND DATE |
|---|-----------------------------------|
| DESIGNED | REVIEWED: |
| CHECKED | DES. CONST. |
| | SDOT PROJ. MGR. |
| DRAWN | RECEIVED |
| CHECKED | REVISED AS BUILT |
| ALL WORK SHALL BE DONE IN ACCORDANCE WITH THE CITY OF SEATTLE STANDARD PLANS AND SPECIFICATIONS AND OTHER DOCUMENTS CALLED FOR IN SECTION 0-02.3 OF THE PROJECT MANUAL. | |

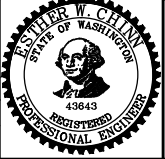

City of Seattle
Seattle Department of Transportation
ORDINANCE NO. APPROVED.
FUND:
SCALE: H. 1"=20', V. 1"=10' INSPECTOR'S BOOK

2015 ARTERIAL ASPHALT
AND CONCRETE
ROOSEVELT WAY NE

| | |
|----------------|---------|
| PC | TA6067A |
| R/W | |
| CO | TA6067C |
| VAULT PLAN NO. | --- |
| SHEET | 15 OF # |

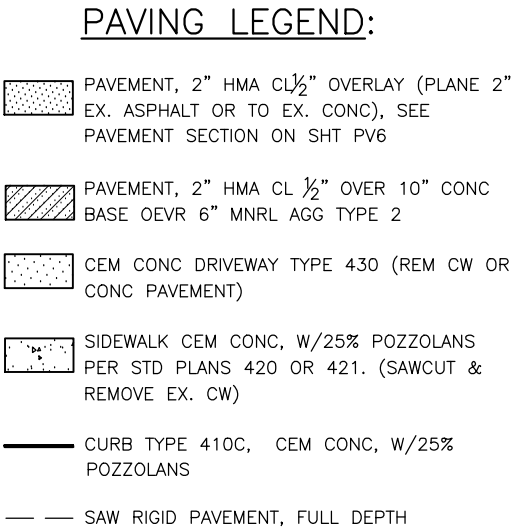

P:\STDrafter\2015_AAC\Roosevelt\A_PLOT FILES\TS0607A-P-ROAD.dwg
May-23-14 8:45am

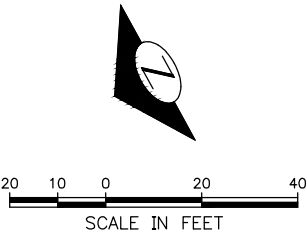

- 1 DETECTABLE WARNING PAD ON EX. WCR
- 2 CURB RAMP, PER STD PLAN TYPE 422



PV14
PAVING PLAN
ADDITIVE 2

| | | | | | | | | |
|---|--|--|---|---|--|--|---|--|
| <div style="border: 1px solid black; padding: 5px; text-align: center;"> 30% REVIEW NOT FOR CONSTRUCTION MAY 2014 </div> | APPROVED FOR ADVERTISING NANCY LOCKE DEPARTMENT OF FINANCE & ADMINISTRATIVE SERVICES SEATTLE, WASHINGTON 20 | NAME OR INITIALS AND DATE DESIGNED _____ CHECKED _____ | INITIALS AND DATE REVIEWED: DES. _____ CONST. _____ SDOT _____ PROJ. MGR. _____ |  | City of Seattle <u>Seattle Department</u> <u>of Transportation</u> | <div style="text-align: center;">  </div> | <div style="text-align: center;"> 2015 ARTERIAL ASPHALT AND CONCRETE ROOSEVELT WAY NE </div> | JOB NO. PC TA6067A R/W CO TA6067C |
| | BY: _____ PURCHASING & CONTRACTING SERVICES DIRECTOR | DRAWN _____ CHECKED _____ | RECEIVED _____ REVISED AS BUILT _____ | | | | | ORDINANCE NO. _____ APPROVED _____ FUND: _____ SCALE: H. 1"=20', V. 1"=10' INSPECTOR'S BOOK, _____ |



C:\STDraft\2015_AAC\Roosevelt\A_PLOT FILES\TS6067A-P-ROAD.dwg
 May-23-14 8:45am



- CONSTRUCTION NOTES:

-

PV15
PAVING PLAN
ADDITIVE 2

| | | | | | | | | |
|--|---|--|---|---|--|--|---|-------------------------------|
| <div style="border: 1px solid black; border-radius: 10px; padding: 5px; margin: 5px auto; width: 80%;"> 30% REVIEW NOT FOR CONSTRUCTION MAY 2014 </div> | APPROVED FOR ADVERTISING NANCY LOCKE DEPARTMENT OF FINANCE & ADMINISTRATIVE SERVICES SEATTLE, WASHINGTON 20 | NAME OR INITIALS AND DATE DESIGNED _____ CHECKED _____ | INITIALS AND DATE REVIEWED: DES. _____ CONST. _____ SDOT _____ PROJ. MGR. _____ |  |  City of Seattle <u>Seattle Department</u> <u>of Transportation</u> | <div style="font-size: 2em; font-weight: bold; margin-bottom: 10px;">2015 ARTERIAL ASPHALT AND CONCRETE ROOSEVELT WAY NE</div> | JOB NO. PC TA6067A R/W CO TA6067C | |
| | BY: _____ PURCHASING & CONTRACTING SERVICES DIRECTOR | DRAWN _____ CHECKED _____ | RECEIVED _____ REVISED AS BUILT _____ | | | | ORDINANCE NO. _____ APPROVED _____ FUND: _____ SCALE: H. 1"=20', V. 1"=10' INSPECTOR'S BOOK _____ | VAULT PLAN NO. _____ _____ |
| | ALL WORK SHALL BE DONE IN ACCORDANCE WITH THE CITY OF SEATTLE STANDARD PLANS AND SPECIFICATIONS AND OTHER DOCUMENTS CALLED FOR IN SECTION 0-02.3 OF THE PROJECT MANUAL. | | | | | | | |
| | | | | | | | | SHEET 17 OF # |

\\STDRafter\2015_AAC\Roosevelt\A_PLOT FILES\TS067A-P-MRKG.dwg
May-23-14 8:45am

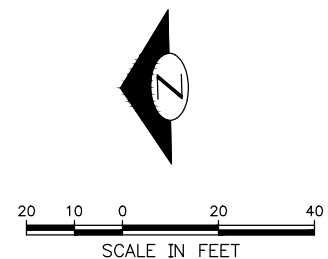



CH1
CHANNELIZATION PLAN
ADDITIVE 1

APPROVED FOR ADVERTISING
NANCY LOCKE
DEPARTMENT OF FINANCE & ADMINISTRATIVE SERVICES
SEATTLE, WASHINGTON 20

BY: _____
PURCHASING & CONTRACTING SERVICES DIRECTOR

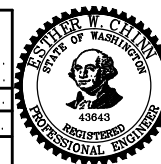
| | | | |
|---|--|-------------------|--------------------|
| NAME OR INITIALS AND DATE | | INITIALS AND DATE | |
| DESIGNED | | REVIEWED: | |
| CHECKED | | DES. | CONST. |
| | | SDOT | PROJ. MGR. |
| DRAWN | | RECEIVED | |
| CHECKED | | REVISED AS BUILT | |
| ALL WORK SHALL BE DONE IN ACCORDANCE WITH THE CITY OF SEATTLE STANDARD PLANS AND SPECIFICATIONS AND OTHER DOCUMENTS CALLED FOR IN SECTION 0-02.3 OF THE PROJECT MANUAL. | | | |





City of Seattle

Seattle Department

of Transportation

ORDINANCE NO.

APPROVED.

FUND:

SCALE: H. 1"=20', V. 1"=10'

INSPECTOR'S BOOK.

2015 ARTERIAL ASPHALT
AND CONCRETE
ROOSEVELT WAY NE

| | | |
|-------------------------|-----|---------|
| JOB NO. | PC | TA6067A |
| | R/W | |
| | CO | TA6067C |
| VAULT PLAN NO. ----- | | |
| SHEET 18 OF # | | |

| Vault Serial No. | Date | Mark | Nature | Revisions |
|------------------|------|------|--------|-----------------|
| | | | | MADE CHKD REV'D |

P:\STDR\2015_AAC\Roosevelt\A_PLOT FILES\TS6067A-P-MRG.dwg
May-23-14 8:45am

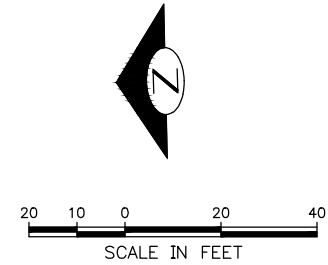
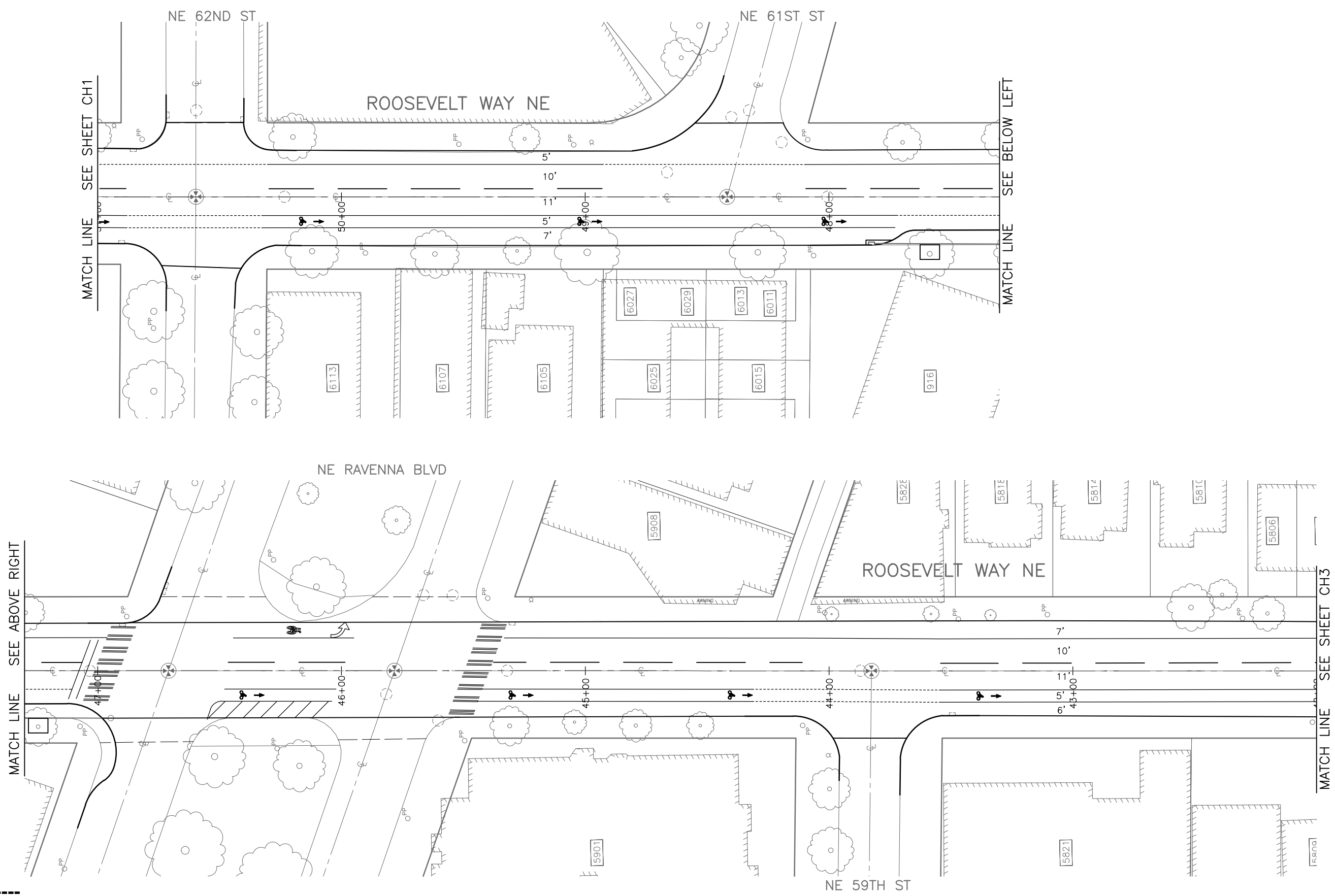

CH2
CHANNELIZATION PLAN
ADDITIVE 1

30% REVIEW
NOT FOR CONSTRUCTION
MAY 2014

APPROVED FOR ADVERTISING
NANCY LOCKE
DEPARTMENT OF FINANCE & ADMINISTRATIVE SERVICES
SEATTLE, WASHINGTON 20
BY: _____
PURCHASING & CONTRACTING SERVICES DIRECTOR

| | |
|---|-----------------------------------|
| NAME OR INITIALS AND DATE | INITIALS AND DATE |
| DESIGNED | REVIEWED: |
| CHECKED | DES. CONST. |
| | SDOT PROJ. MGR. |
| DRAWN | RECEIVED |
| CHECKED | REVISED AS BUILT |
| ALL WORK SHALL BE DONE IN ACCORDANCE WITH THE CITY OF SEATTLE STANDARD PLANS AND SPECIFICATIONS AND OTHER DOCUMENTS CALLED FOR IN SECTION 0-02.3 OF THE PROJECT MANUAL. | |

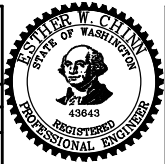

City of Seattle
**Seattle Department
of Transportation**
ORDINANCE NO. APPROVED.
FUND:
SCALE: H. 1"=20', V. 1"=10' INSPECTOR'S BOOK

**2015 ARTERIAL ASPHALT
AND CONCRETE
ROOSEVELT WAY NE**

| | |
|----------------|---------|
| PC | TA6067A |
| R/W | |
| CO | TA6067C |
| Vault Plan No. | --- |
| SHEET | 19 OF # |

| REVISIONS | DATE | MARK | NATURE | MADE |
|-----------|------|------|--------|-------|
| 1 | | | | CHK'D |
| 2 | | | | REV'D |

P:\STDR\2015_AAC\Roosevelt\A_PLOT FILES\TS6067A-P-MRG.dwg
May-23-14 8:45am

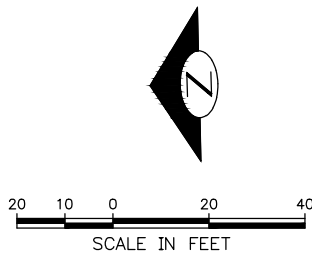
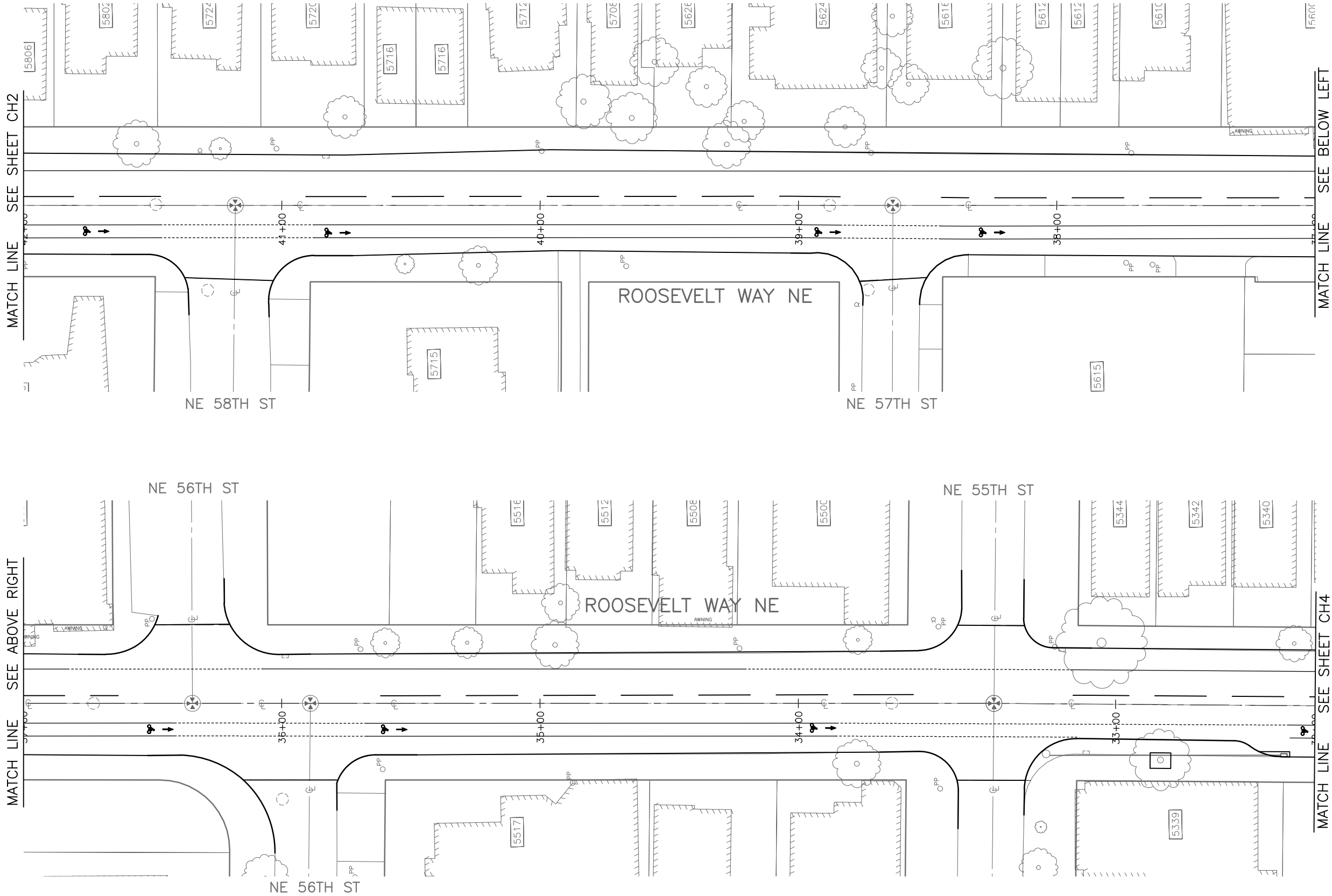

CH3
CHANNELIZATION PLAN
ADDITIVE 1

30% REVIEW
NOT FOR CONSTRUCTION
MAY 2014

APPROVED FOR ADVERTISING
NANCY LOCKE
DEPARTMENT OF FINANCE & ADMINISTRATIVE SERVICES
SEATTLE, WASHINGTON 20
BY: PURCHASING & CONTRACTING SERVICES DIRECTOR

| | |
|---|-----------------------------------|
| NAME OR INITIALS AND DATE | INITIALS AND DATE |
| DESIGNED | REVIEWED: |
| CHECKED | DES. CONST. |
| | SDOT PROJ. MGR. |
| DRAWN | RECEIVED |
| CHECKED | REVISED AS BUILT |
| ALL WORK SHALL BE DONE IN ACCORDANCE WITH THE CITY OF SEATTLE STANDARD PLANS AND SPECIFICATIONS AND OTHER DOCUMENTS CALLED FOR IN SECTION 0-02.3 OF THE PROJECT MANUAL. | |

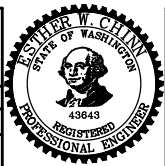

City of Seattle
**Seattle Department
of Transportation**
ORDINANCE NO. APPROVED.
FUND:
SCALE: H. 1"=20', V. 1"=10' INSPECTOR'S BOOK.

2015 ARTERIAL ASPHALT
AND CONCRETE
ROOSEVELT WAY NE

| | |
|-----------------------|---------|
| PC | TA6067A |
| R/W | |
| CO | TA6067C |
| VAULT PLAN NO. --- | |
| SHEET 20 OF # | |

| REVISIONS | DATE | MARK | NATURE | MADE | CHK'D | REV'D |
|-----------|------|------|--------|------|-------|-------|
| --- | --- | --- | --- | --- | --- | --- |

P:\STDrfter\2015_AAC\Roosevelt\A_PLOT FILES\TS6067A-P-MRKG.dwg
May-23-14 8:45am

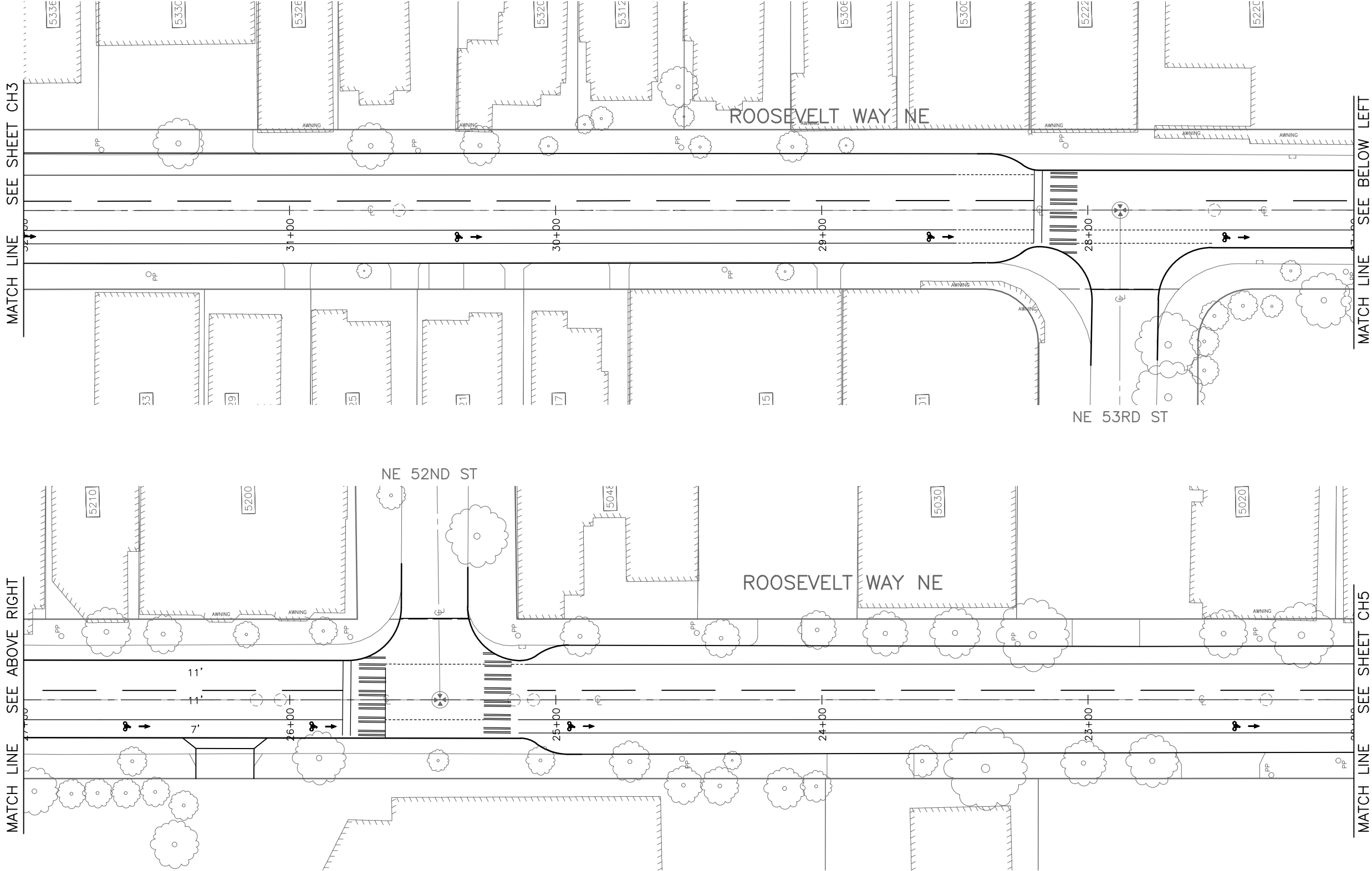

CH4
CHANNELIZATION PLAN
ADDITIVE 1

30% REVIEW
NOT FOR CONSTRUCTION
MAY 2014

APPROVED FOR ADVERTISING
NANCY LOCKE
DEPARTMENT OF FINANCE & ADMINISTRATIVE SERVICES
SEATTLE, WASHINGTON 20
BY: _____
PURCHASING & CONTRACTING SERVICES DIRECTOR

| | |
|---------------------------|-----------------------------------|
| NAME OR INITIALS AND DATE | INITIALS AND DATE |
| DESIGNED | REVIEWED: |
| CHECKED | DES. CONST. |
| | SDOT PROJ. MGR. |
| DRAWN | RECEIVED |
| CHECKED | REVISED AS BUILT |

ALL WORK SHALL BE DONE IN ACCORDANCE WITH THE CITY OF SEATTLE STANDARD PLANS AND SPECIFICATIONS AND OTHER DOCUMENTS CALLED FOR IN SECTION 0-02.3 OF THE PROJECT MANUAL.



City of Seattle
**Seattle Department
of Transportation**
ORDINANCE NO. APPROVED.
FUND:
SCALE: H. 1"=20', V. 1"=10' INSPECTOR'S BOOK.



2015 ARTERIAL ASPHALT
AND CONCRETE
ROOSEVELT WAY NE

| | |
|-----------------------|---------|
| PC | TA6067A |
| R/W | |
| CO | TA6067C |
| VAULT PLAN NO. --- | |
| SHEET 21 OF # | |

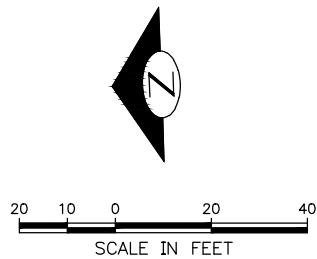
C:\STDraft\2015_AAC\Roosevelt\A_PLOT FILES\TS6067A-P-MRKG.dwg
 May-23-14 8:45am



CH5
CHANNELIZATION PLAN
ADDITIVE 1

| | | | | | | | | |
|---|--|--|--|---|--|--|---|---|
| <div style="border: 1px solid black; padding: 5px; text-align: center;"> 30% REVIEW NOT FOR CONSTRUCTION MAY 2014 </div> | APPROVED FOR ADVERTISING NANCY LOCKE DEPARTMENT OF FINANCE & ADMINISTRATIVE SERVICES SEATTLE, WASHINGTON 20 | NAME OR INITIALS AND DATE DESIGNED ----- CHECKED ----- | INITIALS AND DATE REVIEWED: ----- DES. CONST. SDOT PROJ. MGR. |  | City of Seattle <u>Seattle Department</u> <u>of Transportation</u> | <div style="text-align: center;">  </div> | <div style="text-align: center;"> 2015 ARTERIAL ASPHALT AND CONCRETE ROOSEVELT WAY NE </div> | JOB NO. PC TA6067A R/W CO TA6067C |
| | | DRAWN ----- CHECKED ----- | RECEIVED ----- REVISED AS BUILT ----- | | | | | ORDINANCE NO. APPROVED. FUND: SCALE: H. 1"=20', V. 1"=10' INSPECTOR'S BOOK. |

| Vault | Serial No. | Date | Mark | Nature | Revisions | Made | Checked | Rev'd |
|-------|------------|------|------|--------|-----------|------|---------|-------|
| | | | | | | | | |

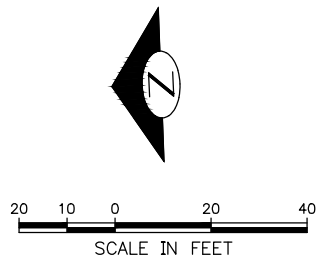
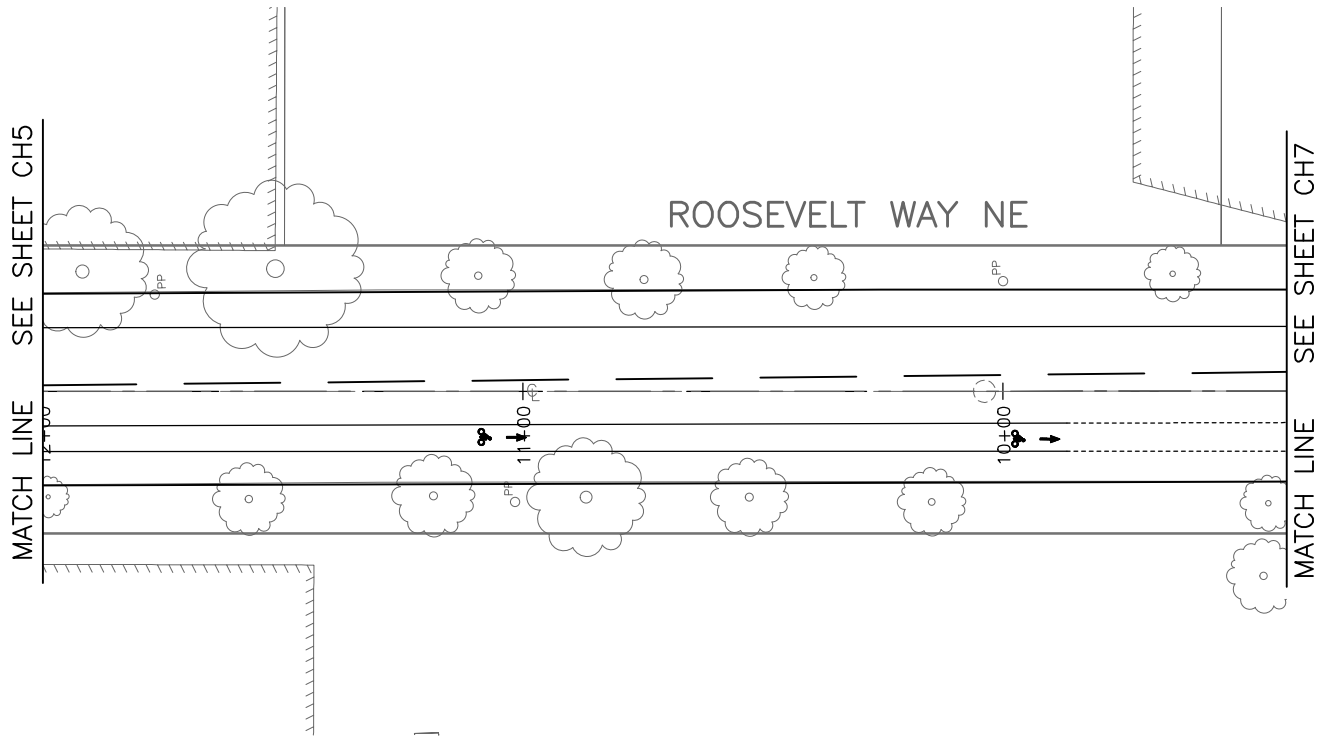

CH6
CHANNELIZATION PLAN
ADDITIVE 1

30% REVIEW
NOT FOR CONSTRUCTION
MAY 2014

APPROVED FOR ADVERTISING
NANCY LOCKE
DEPARTMENT OF FINANCE & ADMINISTRATIVE SERVICES
SEATTLE, WASHINGTON 20
BY:
PURCHASING & CONTRACTING SERVICES DIRECTOR

| NAME OR INITIALS AND DATE | INITIALS AND DATE |
|---|-----------------------------------|
| DESIGNED | REVIEWED: |
| CHECKED | DES. CONST. |
| | SDOT PROJ. MGR. |
| DRAWN | RECEIVED |
| CHECKED | REVISED AS BUILT |
| ALL WORK SHALL BE DONE IN ACCORDANCE WITH THE CITY OF SEATTLE STANDARD PLANS AND SPECIFICATIONS AND OTHER DOCUMENTS CALLED FOR IN SECTION 0-02.3 OF THE PROJECT MANUAL. | |



City of Seattle
**Seattle Department
of Transportation**
ORDINANCE NO. APPROVED.
FUND:
SCALE: H. 1"=20', V. 1"=10' INSPECTOR'S BOOK

2015 ARTERIAL ASPHALT
AND CONCRETE
ROOSEVELT WAY NE

| | |
|-------------------------|---------|
| PC | TA6067A |
| R/W | |
| CO | TA6067C |
| VAULT PLAN NO. ----- | |
| SHEET | 23 OF # |

\\STDRafter\2015_AAC\Roosevelt\A_PLOT FILES\TS067A-P-MRKG.dwg
May-23-14 8:45am

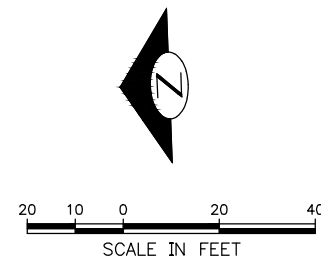
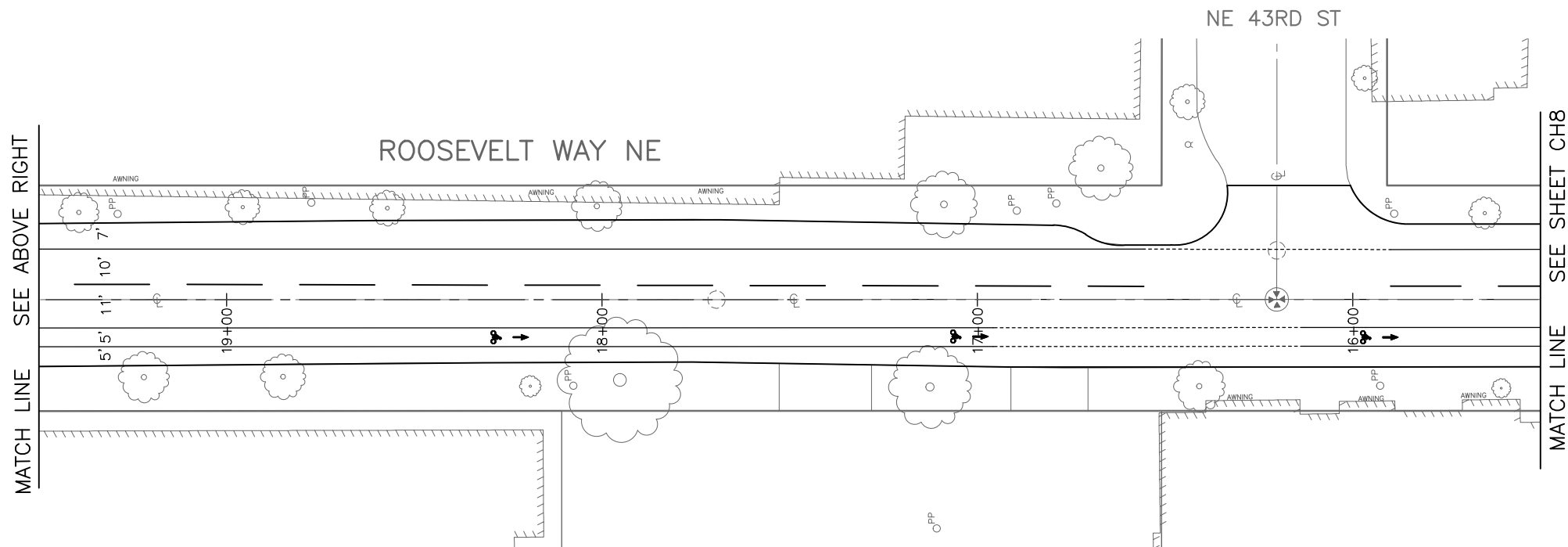

CH7
CHANNELIZATION PLAN
BASE BID

30% REVIEW
NOT FOR CONSTRUCTION
MAY 2014

APPROVED FOR ADVERTISING
NANCY LOCKE
DEPARTMENT OF FINANCE & ADMINISTRATIVE SERVICES
SEATTLE, WASHINGTON 20

By: _____
PURCHASING & CONTRACTING SERVICES DIRECTOR

| | | |
|---|-------------------|--------------------|
| NAME OR INITIALS AND DATE | INITIALS AND DATE | |
| DESIGNED | REVIEWED: | |
| CHECKED | DES. | CONST. |
| | SDOT | PROJ. MGR. |
| DRAWN | RECEIVED | |
| CHECKED | REVISED AS BUILT | |
| ALL WORK SHALL BE DONE IN ACCORDANCE WITH THE CITY OF SEATTLE STANDARD PLANS AND SPECIFICATIONS AND OTHER DOCUMENTS CALLED FOR IN SECTION 0-02.3 OF THE PROJECT MANUAL. | | |

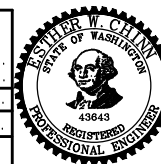



City of Seattle

Seattle Department
of Transportation

ORDINANCE NO.

APPROVED.

FUND:

SCALE: H. 1"=20', V. 1"=10'

INSPECTOR'S BOOK.

2015 ARTERIAL ASPHALT
AND CONCRETE
ROOSEVELT WAY NE

| | | |
|-------------------------|-----|---------|
| JOB NO. | PC | TA6067A |
| | R/W | |
| | CO | TA6067C |
| VAULT PLAN NO. ----- | | |
| SHEET 24 OF # | | |

\\STDRafter\2015_AAC\Roosevelt\A_PLOT FILES\TS6067A-P-MRKG.dwg
May-23-14 8:45am

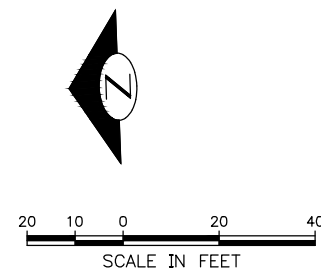
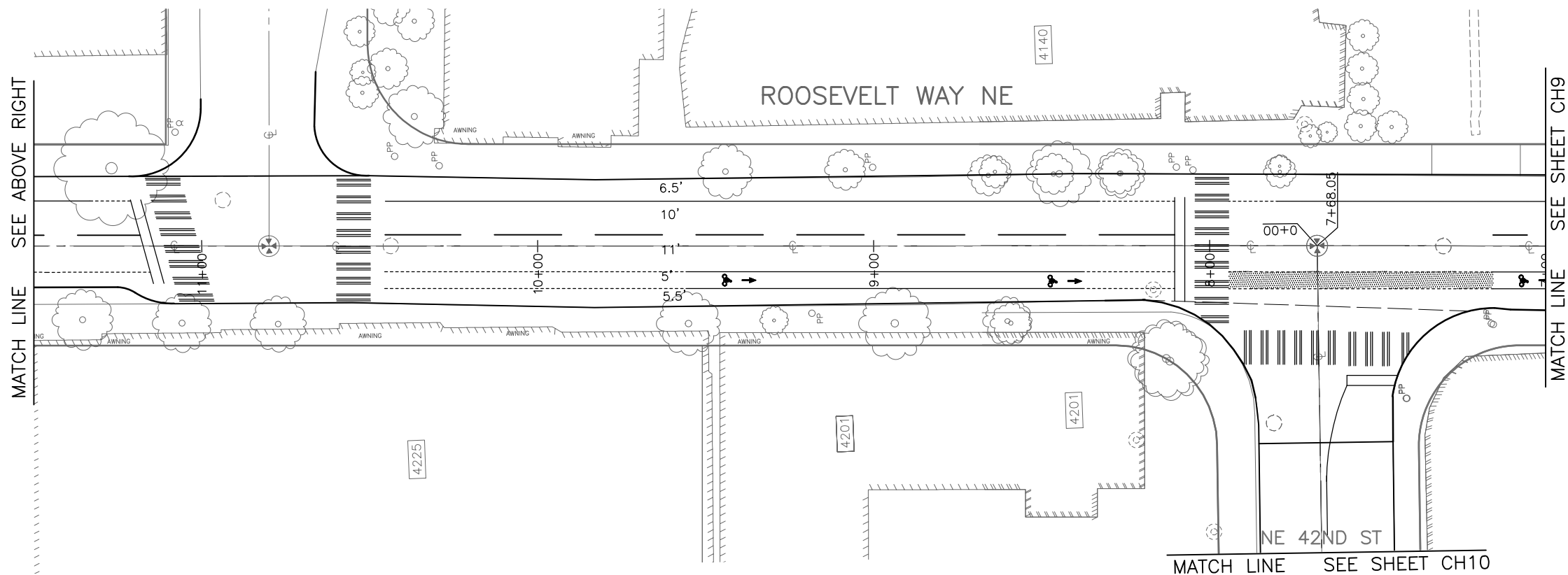

CH8
CHANNELIZATION PLAN
BASE BID

2015 ARTERIAL ASPHALT
AND CONCRETE
ROOSEVELT WAY NE

| | | |
|-------------------------|-----|---------|
| JOB NO. | PC | TA6067A |
| | R/W | |
| | CO | TA6067C |
| VAULT PLAN NO. ----- | | |
| SHEET 25 OF # | | |

30% REVIEW
NOT FOR CONSTRUCTION
MAY 2014

APPROVED FOR ADVERTISING
NANCY LOCKE
DEPARTMENT OF FINANCE & ADMINISTRATIVE SERVICES
SEATTLE, WASHINGTON 20

By: _____
PURCHASING & CONTRACTING SERVICES DIRECTOR

| | | | |
|---|--|----------------------------|--------------------|
| NAME OR INITIALS AND DATE | | INITIALS AND DATE | |
| DESIGNED | | REVIEWED: | |
| CHECKED | | DES. | CONST. |
| | | SDOT | PROJ. MGR. |
| DRAWN | | RECEIVED | |
| CHECKED | | REVISED AS BUILT | |
| ALL WORK SHALL BE DONE IN ACCORDANCE WITH THE CITY OF SEATTLE STANDARD PLANS AND SPECIFICATIONS AND OTHER DOCUMENTS CALLED FOR IN SECTION 0-02.3 OF THE PROJECT MANUAL. | | | |

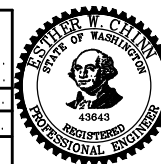

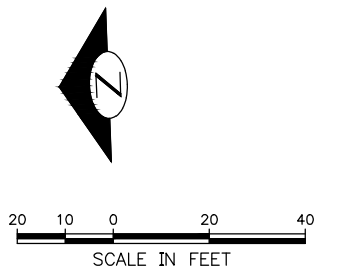
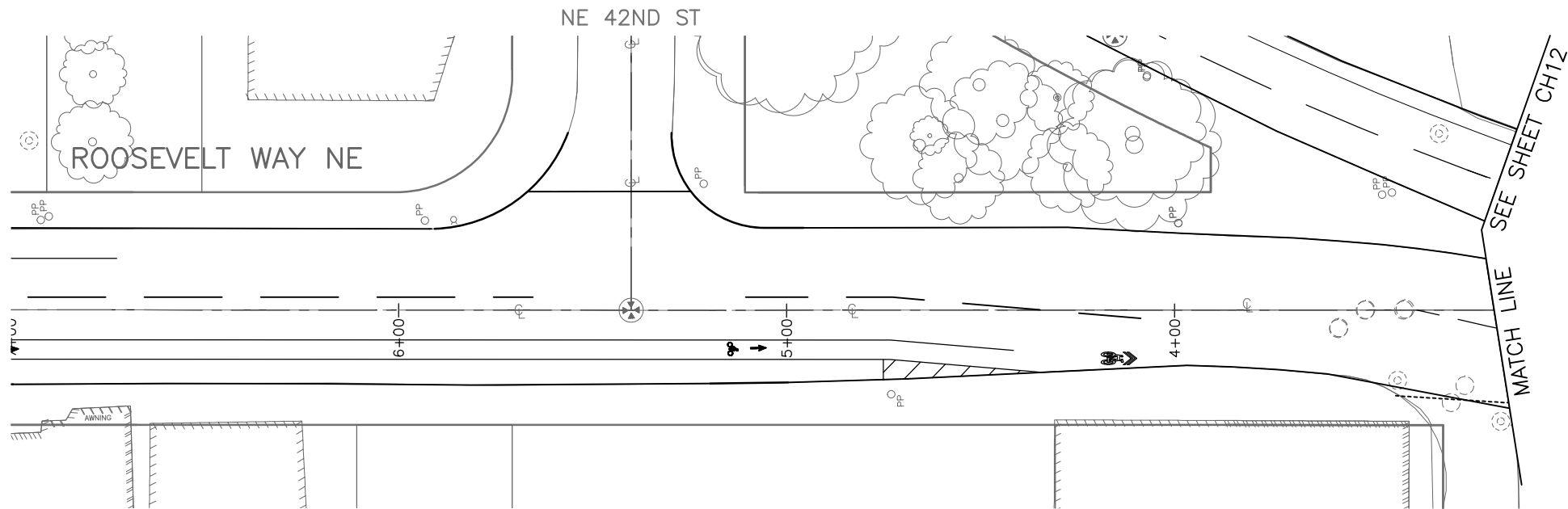

 City of Seattle
***Seattle Department
of Transportation***



CH9
CHANNELIZATION PLAN
BASE BID

| | | |
|----------------|-----|---------|
| JOB NO. | PC | TA6067A |
| | R/W | |
| | CO | TA6067C |
| VAULT PLAN NO. | | |
| ----- | | |
| SHEET 26 OF # | | |

2015 ARTERIAL ASPHALT
AND CONCRETE
ROOSEVELT WAY NE



City of Seattle
**Seattle Department
of Transportation**

ORDINANCE NO. APPROVED.
FUND:
SCALE: H. 1"=20', V. 1"=10' INSPECTOR'S BOOK



| NAME OR INITIALS AND DATE | | INITIALS AND DATE | |
|---|--|-------------------|--------------------|
| DESIGNED | | REVIEWED: | |
| CHECKED | | DES. | CONST. |
| | | SDOT | PROJ. MGR. |
| DRAWN | | RECEIVED | |
| CHECKED | | REVISED AS BUILT | |
| ALL WORK SHALL BE DONE IN ACCORDANCE WITH THE CITY OF SEATTLE STANDARD PLANS AND SPECIFICATIONS AND OTHER DOCUMENTS CALLED FOR IN SECTION 0-02.3 OF THE PROJECT MANUAL. | | | |

APPROVED FOR ADVERTISING
NANCY LOCKE
DEPARTMENT OF FINANCE & ADMINISTRATIVE SERVICES
SEATTLE, WASHINGTON 20
BY:
PURCHASING & CONTRACTING SERVICES DIRECTOR

30% REVIEW
NOT FOR CONSTRUCTION
MAY 2014

| VAULT SERIAL NO. | DATE | MARK | NATURE | MADE | CHK'D | REV'D |
|------------------|------|------|-----------|------|-------|-------|
| ---- | | | REVISIONS | | | |

| Vault | Serial No. | Date | Mark | Nature | Revisions | Made | Checked | Rev'd |
|-------|------------|------|------|--------|-----------|------|---------|-------|
| | | | | | | | | |

P:\STDrifter\2015_AAC\Roosevelt\A_PLOT FILES\TS6067A-P-MRKG.dwg
May-23-14 8:45am

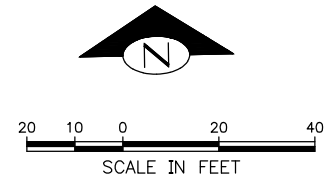
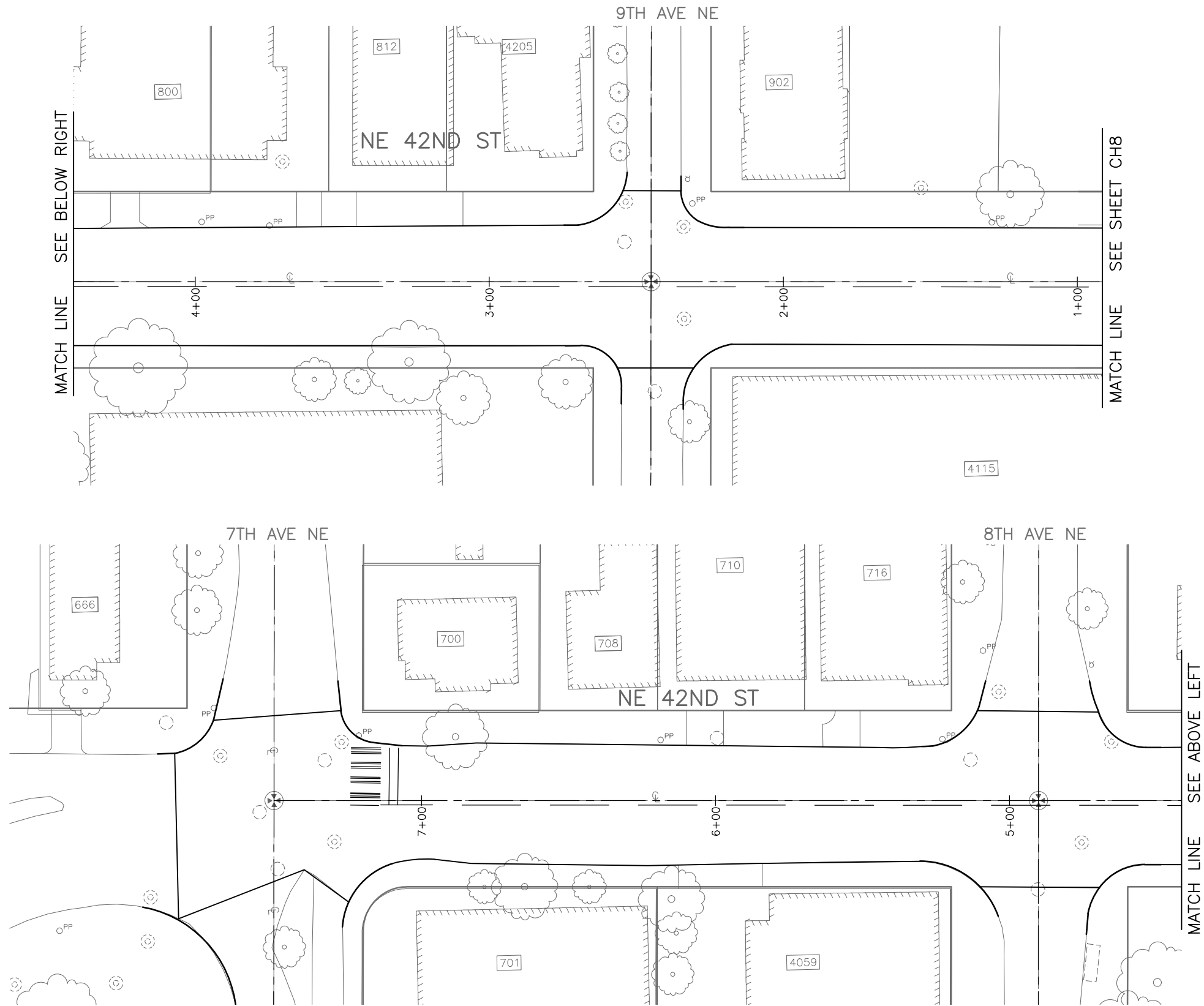

CH10
CHANNELIZATION PLAN
ADDITIVE 3

30% REVIEW
NOT FOR CONSTRUCTION
MAY 2014

APPROVED FOR ADVERTISING
NANCY LOCKE
DEPARTMENT OF FINANCE & ADMINISTRATIVE SERVICES
SEATTLE, WASHINGTON 20
BY: _____
PURCHASING & CONTRACTING SERVICES DIRECTOR

| | |
|---|-----------------------------------|
| NAME OR INITIALS AND DATE | INITIALS AND DATE |
| DESIGNED | REVIEWED: |
| CHECKED | DES. CONST. |
| | SDOT PROJ. MGR. |
| DRAWN | RECEIVED |
| CHECKED | REVISED AS BUILT |
| ALL WORK SHALL BE DONE IN ACCORDANCE WITH THE CITY OF SEATTLE STANDARD PLANS AND SPECIFICATIONS AND OTHER DOCUMENTS CALLED FOR IN SECTION 0-02.3 OF THE PROJECT MANUAL. | |

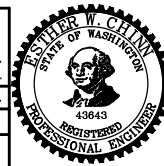

City of Seattle
**Seattle Department
of Transportation**
ORDINANCE NO. APPROVED.
FUND:
SCALE: H. 1"=20', V. 1"=10' INSPECTOR'S BOOK.

**2015 ARTERIAL ASPHALT
AND CONCRETE
ROOSEVELT WAY NE**

| | |
|-------------------------|---------|
| PC | TA6067A |
| R/W | |
| CO | TA6067C |
| VAULT PLAN NO. ----- | |
| SHEET 27 OF # | |

C:\STDraft\2015_AAC\Roosevelt\A_PLOT FILES\TS6067A-P-MRK.G.dwg
 May-23-14 8:45am

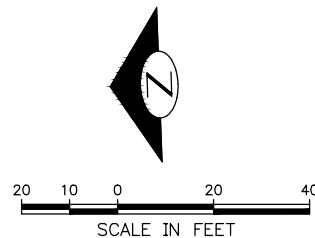

CH11
CHANNELIZATION PLAN
ADDITIVE 3

| | | | | | | | |
|---|--|---|--|---|---|---|---|
| <div style="border: 1px solid black; padding: 5px; text-align: center;"> 30% REVIEW NOT FOR CONSTRUCTION MAY 2014 </div> | APPROVED FOR ADVERTISING NANCY LOCKE DEPARTMENT OF FINANCE & ADMINISTRATIVE SERVICES SEATTLE, WASHINGTON 20 | NAME OR INITIALS AND DATE DESIGNED _____ CHECKED _____ DRAWN _____ CHECKED _____ | INITIALS AND DATE REVIEWED: _____ DES. _____ CONST. _____ SDOT _____ PROJ. MGR. _____ RECEIVED _____ REVISED AS BUILT _____ |  | City of Seattle Seattle Department of Transportation ORDINANCE NO. _____ APPROVED _____ FUND: _____ SCALE: H. 1"=20', V. 1"=10' INSPECTOR'S BOOK _____ | <div style="text-align: center;"> 2015 ARTERIAL ASPHALT AND CONCRETE ROOSEVELT WAY NE </div> | JOB NO. PC TA6067A R/W CO TA6067C |
| | BY: _____ PURCHASING & CONTRACTING SERVICES DIRECTOR | ALL WORK SHALL BE DONE IN ACCORDANCE WITH THE CITY OF SEATTLE STANDARD PLANS AND SPECIFICATIONS AND OTHER DOCUMENTS CALLED FOR IN SECTION 0-02.3 OF THE PROJECT MANUAL. | VAULT PLAN NO. _____ SHEET 28 OF # | | | | |

| Vault Serial No. | Date | Mark | Nature | Revisions | Made | Checked | Rev'd |
|------------------|------|------|--------|-----------|------|---------|-------|
| | | | | | | | |

P:\STDrifter\2015_AAC\Roosevelt\A_PLOT FILES\TS6067A-P-MRKG.dwg
May-23-14 8:45am

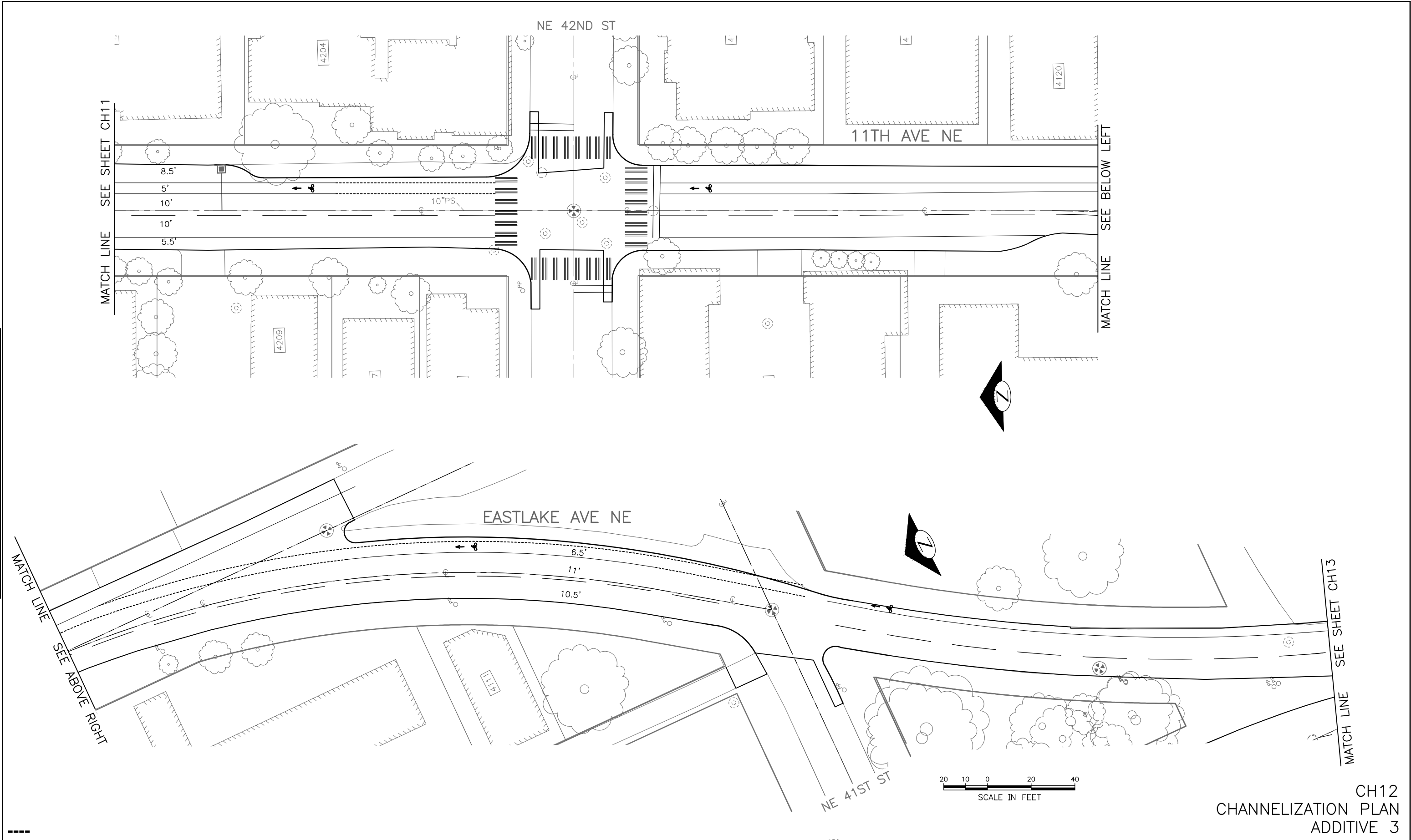

CH12
CHANNELIZATION PLAN
ADDITIVE 3

30% REVIEW
NOT FOR CONSTRUCTION
MAY 2014

APPROVED FOR ADVERTISING
NANCY LOCKE
DEPARTMENT OF FINANCE & ADMINISTRATIVE SERVICES
SEATTLE, WASHINGTON 20
BY: PURCHASING & CONTRACTING SERVICES DIRECTOR

| | |
|---|-----------------------------------|
| NAME OR INITIALS AND DATE | INITIALS AND DATE |
| DESIGNED | REVIEWED: |
| CHECKED | DES. CONST. |
| | SDOT PROJ. MGR. |
| DRAWN | RECEIVED |
| CHECKED | REVISED AS BUILT |
| ALL WORK SHALL BE DONE IN ACCORDANCE WITH THE CITY OF SEATTLE STANDARD PLANS AND SPECIFICATIONS AND OTHER DOCUMENTS CALLED FOR IN SECTION 0-02.3 OF THE PROJECT MANUAL. | |

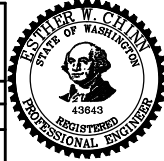

City of Seattle
Seattle Department of Transportation
ORDINANCE NO. APPROVED.
FUND:
SCALE: H. 1"=20', V. 1"=10' INSPECTOR'S BOOK

2015 ARTERIAL ASPHALT AND CONCRETE ROOSEVELT WAY NE

| | |
|------------------------|---------|
| PC | TA6067A |
| R/W | |
| CO | TA6067C |
| VAULT PLAN NO. | |
| SHEET 29 OF # | |

| VAULT SERIAL NO. | DATE | MARK | NATURE | MADE CHK'D | REV'D |
|------------------|------|------|--------|------------|-------|
| --- | | | | | |
| REVISIONS | | | | | |

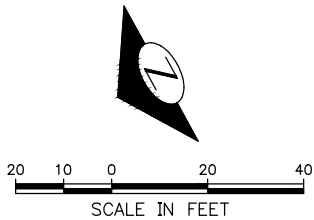
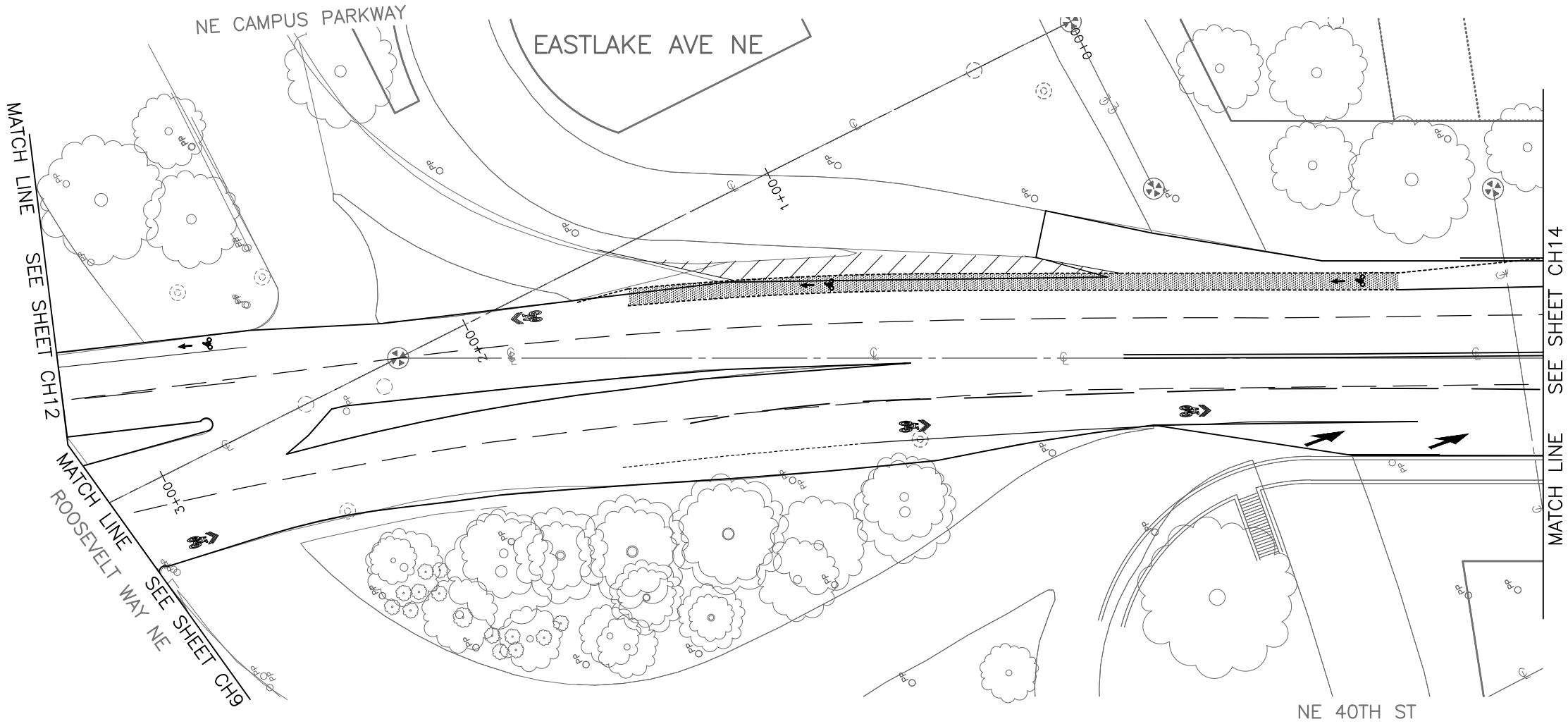

CH13
CHANNELIZATION PLAN
ADDITIVE 2

30% REVIEW
NOT FOR CONSTRUCTION
MAY 2014

APPROVED FOR ADVERTISING
NANCY LOCKE
DEPARTMENT OF FINANCE & ADMINISTRATIVE SERVICES
SEATTLE, WASHINGTON 20
BY:
PURCHASING & CONTRACTING SERVICES DIRECTOR

| NAME OR INITIALS AND DATE | INITIALS AND DATE |
|---|-----------------------------------|
| DESIGNED | REVIEWED: |
| CHECKED | DES. CONST. |
| | SDOT PROJ. MGR. |
| DRAWN | RECEIVED |
| CHECKED | REVISED AS BUILT |
| ALL WORK SHALL BE DONE IN ACCORDANCE WITH THE CITY OF SEATTLE STANDARD PLANS AND SPECIFICATIONS AND OTHER DOCUMENTS CALLED FOR IN SECTION 0-02.3 OF THE PROJECT MANUAL. | |

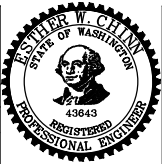

City of Seattle
Seattle Department of Transportation
ORDINANCE NO. APPROVED.
FUND:
SCALE: H. 1"=20', V. 1"=10' INSPECTOR'S BOOK

2015 ARTERIAL ASPHALT
AND CONCRETE
ROOSEVELT WAY NE

| | |
|----------------|---------|
| PC | TA6067A |
| R/W | |
| CO | TA6067C |
| VAULT PLAN NO. | --- |
| SHEET | 30 OF # |

| VAULT SERIAL NO. | DATE | MARK | NATURE | MADE | CHK'D | REV'D |
|------------------|------|------|--------|------|-------|-------|
| | | | | | | |

P:\STDrafter\2015_AAC\Roosevel\A_PLOT FILES\TS6067A-P-MRKg.dwg
May-23-14 8:45am

MATCH LINE SEE SHEET CH13

MATCH LINE SEE ABOVE RIGHT

MATCH LINE SEE BELOW LEFT

MATCH LINE SEE SHEET CH15

EASTLAKE AVE NE

NE PACIFIC ST

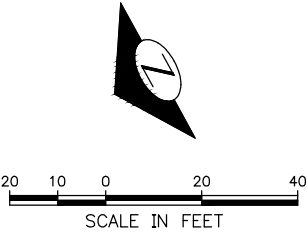

CH14
CHANNELIZATION PLAN
ADDITIVE 2

2015 ARTERIAL ASPHALT
AND CONCRETE
ROOSEVELT WAY NE

30% REVIEW
NOT FOR CONSTRUCTION
MAY 2014

APPROVED FOR ADVERTISING
NANCY LOCKE
DEPARTMENT OF FINANCE & ADMINISTRATIVE SERVICES
SEATTLE, WASHINGTON 20
BY:
PURCHASING & CONTRACTING SERVICES DIRECTOR

| | |
|---|-----------------------------------|
| NAME OR INITIALS AND DATE | INITIALS AND DATE |
| DESIGNED | REVIEWED: |
| CHECKED | DES. CONST. |
| | SDOT PROJ. MGR. |
| DRAWN | RECEIVED |
| CHECKED | REVISED AS BUILT |
| ALL WORK SHALL BE DONE IN ACCORDANCE WITH THE CITY OF SEATTLE STANDARD PLANS AND SPECIFICATIONS AND OTHER DOCUMENTS CALLED FOR IN SECTION 0-02.3 OF THE PROJECT MANUAL. | |

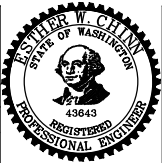

City of Seattle
**Seattle Department
of Transportation**
ORDINANCE NO. APPROVED.
FUND:
SCALE: H. 1"=20', V. 1"=10' INSPECTOR'S BOOK.

| | | |
|-------------------------|-----|---------|
| JOB NO. | PC | TA6067A |
| | R/W | |
| | CO | TA6067C |
| VAULT PLAN NO. ----- | | |
| SHEET 31 OF # | | |

| VAULT SERIAL NO. | DATE | MARK | NATURE REVISIONS | MADE CHK'D | REV'D |
|------------------|------|------|---------------------|------------|-------|
| | | | | | |
| | | | | | |
| | | | | | |
| | | | | | |

MATCH LINE SEE SHEET CH14

EASTLAKE AVE NE

FUHRMAN AVE E

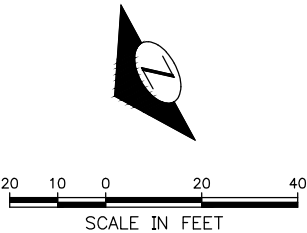

CH15
CHANNELIZATION PLAN
ADDITIVE 2

30% REVIEW
NOT FOR CONSTRUCTION
MAY 2014

APPROVED FOR ADVERTISING
NANCY LOCKE
DEPARTMENT OF FINANCE & ADMINISTRATIVE SERVICES
SEATTLE, WASHINGTON 20
BY:
PURCHASING & CONTRACTING SERVICES DIRECTOR

| NAME OR INITIALS AND DATE | INITIALS AND DATE |
|---|--|
| DESIGNED | REVIEWED: DES. CONST. |
| CHECKED | SDOT PROJ. MGR. |
| DRAWN | RECEIVED |
| CHECKED | REVISED AS BUILT |
| ALL WORK SHALL BE DONE IN ACCORDANCE WITH THE CITY OF SEATTLE STANDARD PLANS AND SPECIFICATIONS AND OTHER DOCUMENTS CALLED FOR IN SECTION 0-02.3 OF THE PROJECT MANUAL. | |



City of Seattle
**Seattle Department
of Transportation**
ORDINANCE NO. APPROVED.
FUND:
SCALE: H. 1"=20', V. 1"=10' INSPECTOR'S BOOK

2015 ARTERIAL ASPHALT
AND CONCRETE
ROOSEVELT WAY NE

| | |
|----------------|---------|
| PC | TA6067A |
| R/W | |
| CO | TA6067C |
| VAULT PLAN NO. | ---- |
| SHEET | 32 OF # |